

Applications

Lifting of steel drums – full or empty - in vertical position and with diameter 600 mm.

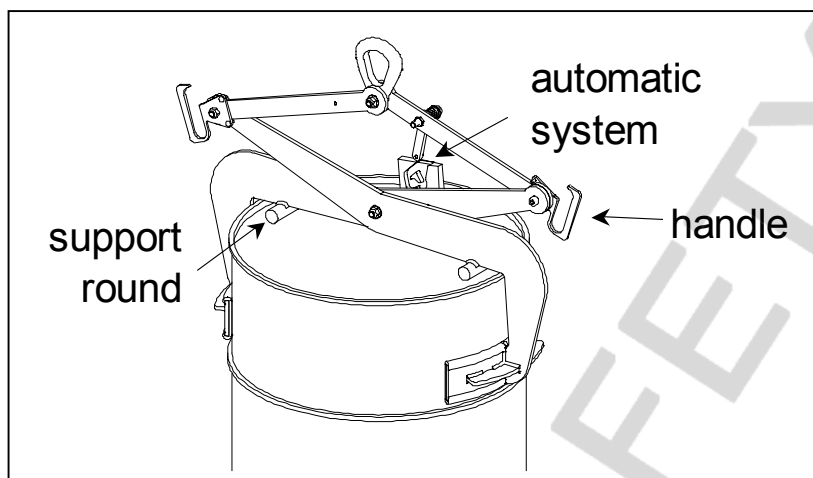
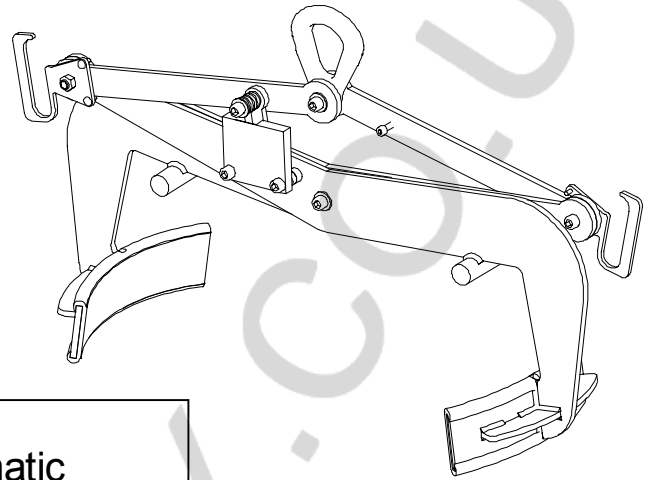

Description

Accessory equipped with an automatic system allowing to grip and lay down the drum without any manual intervention. Rubber coated pads ensure a great adherence and avoid marking the drums. Transport handles make the positioning easier. Support rounds ensure the clamp's stability when it is laid down on the drum. Clamping is proportional to the load, thus minimising drum's deformation risk.

Functioning

Place the open clamp over the drum and activate the lifting means. The clamp grips automatically the load. When laying down, the operator must lower completely the clamp onto the drum so as to activate the automatic locking system. The clamp is then locked open.

Particular instructions

- Make sure the pads are free from grease or oil.
- Do not lift greasy or oily drums.
- Not suitable for plastic drums.
- Do not lift drums with sizes exceeding the opening capacity of the clamp used.
- Drum deformation risk when lifting open drums (without lid).
- Working temperature: -20° to +90°C.

technical sheet	VFA	ref. :	T 6025 GB
	automatic clamp for vertical steel drum lifting	rev. :	2
		date :	Jun. 03
		page :	2 / 2

General characteristics

- Manufacture without load bearing welds.
- Hot epoxy coating.
- Safety factor: 4 in accordance with the European Materials Handling Federation (1998 FEM 3rd edition) ; working group A5 and lifting speed 60 m/ mn.

Dimensional characteristics

Ref.	Group code	WLL kg	Drum \varnothing	A		B		C		D		E	F	G	H	I	J	Jaws length L	Weight kg
				min	max	min	max	min	max	min	max								
VFA 025	51208	300	600	530	672	840	850	975	993	237	243	20	117	80	64	23	96	310	27

Dimensions in mm

