

**Applications**

Lifting of containers by their standard ISO corners.

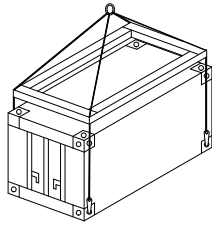

**CCV**

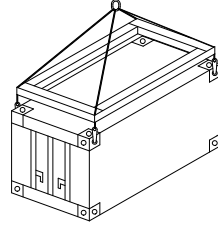

**CC7.5 B**

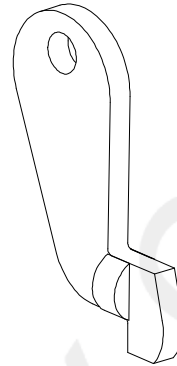

**CC7.5V**

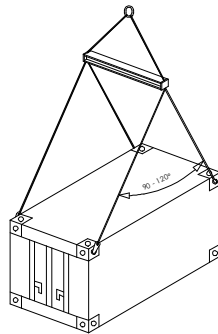

**CCB**

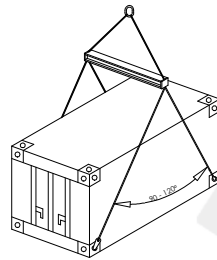

**CC12.5 B**

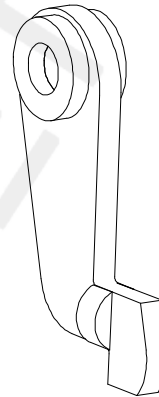

**CC12.5 V**

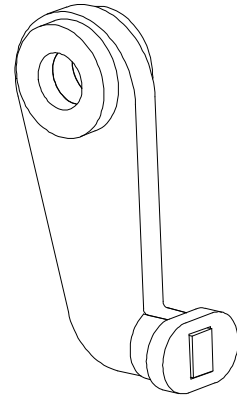

**Description**

2 models:  
CCB: container lifted by the top or bottom, slantwise traction.  
CCV: container lifted by the top or bottom, vertical traction.  
Slings not provided.

**Functioning**

CCB: lifting with a single lifting beam and two 2-legged slings.  
CCV: lifting with a spreader frame and 4 slings.

**Important instructions**

- Capacity of CCB model is specified on axle direction of the hook. Weight of container which can be lifted depends on sling angle.
- Do not use container lugs meant for slantwise traction (CCB) to pull vertically and vice versa.
- CCB container lugs for slantwise traction: adhere to a sling angle included between 90 and 120°.
- Working temperature: -20° to +100°C.

**General characteristics**

- Manufactured without load bearing welds.
- Hot epoxy coating.
- Safety factor: 3 in accordance with the EN 13155.2003 norm.
- Product conforms to the French regulation, in particular the decree of 01/03/2004 relating to the check on lifting devices and the European Directive n°2006/42.
- Product with EC marking and delivered with a declaration of conformity and instructions for use.

**Dimensional characteristics**

Ref.	Group code	WLL/ 4 kg	Traction	A	B	C	D	E	F	G	H	I	J	Weight/ 4 kg
CCV7,5	50038	30 000	vertical	16	55	32	160	44	99	X	20	50	77	16
CCV12,5	50048	50 000		25	55	40	160	44	99	50	20	50	77	20
CCB7,5	50058	30 000*	slantwise	16	55	32	145	64	119	X	20	72	50	16
CCB12,5	50068	50 000*		25	55	40	160	74	129	50	20	73	50	20

\* IMPORTANT : control real capacity considering sling angle

Dimensions in mm

