



McKissick®
M-491 Tower/Derrick Hoist Blocks

M-491 Tower/Derrick Hoist Blocks

New design provides the dependability of standard McKissick® snatch blocks, along with features that make it perfect for the challenging needs of Tugger Hoist and Tower Erection applications.

- A wide variety of configurations:
 - o 4, 8, 12 or 15 metric ton capacity
 - o 3/8", 7/16", 1/2", 9/16", 5/8", 7/8" and 1" wireline sizes / 10 to 25 mm wire line sizes
 - o Painted or Galvanized finish
- 8" and 10" block furnished with dual rated wireline sheaves
- Forged steel swivels, tees, yokes and shackles are Quenched & Tempered.
- Sheave lubrication through center pin for easy maintenance.
- Design factor of 4 to 1
- All blocks 14" and larger are furnished with McKissick® Roll Forged™ sheaves with flame hardened grooves.
- Recessed side plate design reduces the gap between the sheave rim and the side plate, allowing the sheave assembly to be captured in the block if loss of center pin occurs.
- Sealed tapered roller bearings extend the life of the center pin and bearings, and allows for faster line speeds than recommended with standard snatch blocks.
- Shackle fitting swivels for easy positioning.
- Suitable for hoisting personnel, contingent upon all employees, including the winch operator, trained to follow any applicable Federal, local and industry standards.
 - o Tugger/Derrick applications: API RP54
 - o Tower applications: OSHA directive CPL 2-1.36
- Holes through side plates are available for secondary block securement device.
- Manufactured by an API Q1 Certified facility
- Type Approved and certification in accordance with ABS 2006 Steel Vessel Rules 1-1-17.7, and ABS Guide for Certification and Cranes.
- All sizes are **RFID EQUIPPED**.

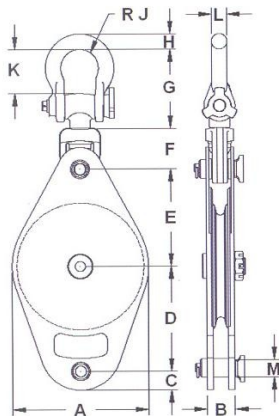

WLL (t)	Sheave Diameter (Inches)	Wire Rope Size (mm)	A (mm)	B (mm)	C (mm)	D (mm)	E (mm)	F (mm)	G (mm)	H (mm)	J (mm)	K (mm)	L (mm)	M (mm)	M-491S Stock No. Painted	M-491G Stock No. Galvanized
4	8	10-13	226	48	28	171	159	81	102	18	22	51	16	19	2020161	2020170
8	10	10-13	276	57	38	213	197	84	159	32	38	86	32	25	2020806	2020815
8	10	13-14	276	57	38	213	197	84	159	32	38	86	32	25	2020824	2020833
12	10	13-14	276	57	38	213	197	83	159	32	38	86	32	25	2021118	2021127
12	14	16	378	57	38	264	248	83	159	32	38	86	32	25	2021136	2021145
12	14	19	378	57	38	264	248	83	159	32	38	86	32	25	2021154	2021163
15	16	22	432	77	60	305	298	97	170	44	40	79	38	32	2021172	2021181
15	16	25	432	77	60	305	298	97	170	44	40	79	38	32	2021190	2021199

NOTE: all dimensions are for reference only, dimensions may change at any time without prior notice. Dimensions are rounded – no decimals.

