

# McKissick® Sheaves

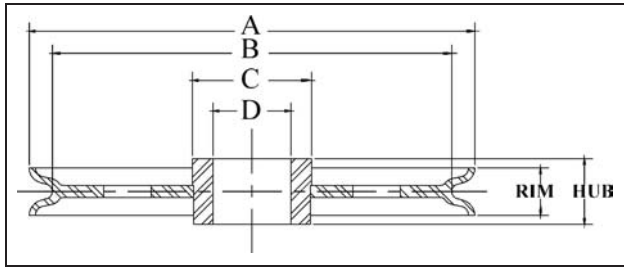

**SEE APPLICATION AND WARNING INFORMATION**

Para Español: [www.thecrosbygroup.com](http://www.thecrosbygroup.com) See Pages 342-349

**SELBY ENGINEERING & LIFTING SAFETY LTD.**  
 Lifting Equipment and Height Safety Specialists  
[www.liftingsafety.co.uk](http://www.liftingsafety.co.uk) sales@liftingsafety.co.uk  
 Tel: +44 (0) 1977 684 600 Fax: +44 (0) 1977 685 300

## Finished Bore Sheaves

- Roll Forged™ sheaves are available in sizes up to 72" in diameter.
- McKissick® Finished Bore Sheaves can be equipped with bushings or bearings at an optional charge.
- 14" diameter sheaves and larger are Roll Forged™ with Flame hardened grooves to minimum Rockwell 35C.

"A" Nominal Outside Diameter (in.)*	Stock No.	Pattern Number	Wire Line Size (in.)	"D" Bore Size (in.)	Hub Width (in.)	Rim Width (in.)	"C" Nominal Hub Outside Dia. (in.)	"B" Nominal Tread Dia. (in.)	Material	Approx. Weight (lbs.)
3	51008	3X	1/4	.752	1-5/16	1-1/4	1-1/8	2-1/16	B.S.	1.00
3	11310	3X	3/8	.752	1-5/16	1-1/4	1-1/8	2-1/16	B.S.	1.00
-	-	-	-	-	-	-	-	-	-	-
4	51053	4-1	1/8	1.569	1	7/8	2	3-1/8	B.S.	2.00
4	51044	4-1	1/4	1.569	1	7/8	2	3-1/8	B.S.	2.00
4	1189	4-1	3/8	1.569	1	7/8	2	3-1/8	B.S.	2.00
-	-	-	-	-	-	-	-	-	-	-
4	2023185	4-K	3/8	1.569	1-1/2	1-3/8	2	3	F.S.	3.50
4	2023182	4-K	1/2	1.569	1-1/2	1-3/8	2	3	F.S.	3.50
4	51026	4-K	5/8	1.569	1-1/2	1-3/8	2	3	F.S.	3.50
-	-	-	-	-	-	-	-	-	-	-
4-1/4	50553	4-E	3/8	.814	1-3/16	15/16	2-1/8	3-1/8	B.S.	2.40
4-1/4	25939	4-E	1/2	.814	1-3/16	15/16	2-1/8	3-1/8	B.S.	2.40
-	-	-	-	-	-	-	-	-	-	-
4-3/4	51222	5-2	5/16	.875	1-9/16	1-3/8	1-1/2	3-5/8	D.I.	3.50
4-3/4	51231	5-2	3/8	.875	1-9/16	1-3/8	1-1/2	3-5/8	D.I.	3.50
4-3/4	11622	5-2	1/2	.875	1-9/16	1-3/8	1-1/2	3-5/8	D.I.	3.50
-	-	-	-	-	-	-	-	-	-	-
4-7/8	2026411	5-1-B	3/8	1.749	1-1/4	1-1/8	2-1/4	4-1/16	F.S.	3.60
4-7/8	62149	5-1-B	3/8	1.848	1-5/16	1-1/8	2-1/4	4-1/16	F.S.	2.50
4-7/8	2026413	5-1-B	1/2	1.749	1-1/4	1-1/8	2-1/4	4-1/16	F.S.	3.60
4-7/8	2026409	5-1-B	5/8	1.749	1-1/4	1-1/8	2-1/4	4-1/16	F.S.	3.60
-	-	-	-	-	-	-	-	-	-	-
5	51071	5-1	5/16	1.125	1	7/8	1-1/2	4	F.S.	2.50
5	51062	5-1	3/8	1.125	1	7/8	1-1/2	4	F.S.	2.50
5	25948	5-1	7/16	1.125	1	7/8	1-1/2	4	F.S.	2.50
-	-	-	-	-	-	-	-	-	-	-
5-1/4	2026426	6-6	5/8	1.569	1-1/2	1-3/8	2-1/16	3-7/8	F.S.	4.00
5-1/4	2026422	6-6	3/4	1.569	1-1/2	1-3/8	2-1/16	3-7/8	F.S.	4.00
-	-	-	-	-	-	-	-	-	-	-
5-7/8	2023133	6-2	5/8	1.875	1-3/4	1-5/8	2-1/2	4-3/8	F.S.	6.00
5-7/8	2023136	6-2	3/4	1.875	1-3/4	1-5/8	2-1/2	4-3/8	F.S.	6.00
5-7/8	51302	6-2	7/8	1.875	1-3/4	1-5/8	2-1/2	4-3/8	F.S.	6.00
-	-	-	-	-	-	-	-	-	-	-
6	51124	6-1-B	3/8	1.625	1-1/8	1	2-1/4	4-15/16	F.S.	4.00
6	51375	6-8	1/2	1.375	1-1/2	1-1/4	3-1/8	4-3/4	B.S.	7.00
6	13014	6-1-B	1/2	1.625	1-1/8	1	2-1/4	4-15/16	F.S.	4.00
6	60695	6-8	1/2	2.375	1-3/4	1-1/4	3-1/8	4-3/4	F.S.	4.70
6	2023263	6NS-2	5/8	2.500	2-5/16	2-3/16	3-1/8	4-1/4	F.S.	9.50
6	1410	6-8	3/4	1.375	1-1/2	1-1/4	3-1/8	4-3/4	B.S.	7.00
6	2023257	6NS-2	3/4	2.500	2-5/16	2-3/16	3-1/8	4-1/4	F.S.	9.50
6	2023261	6NS-2	7/8	2.500	2-5/16	2-3/16	3-1/8	4-1/4	F.S.	9.50
-	-	-	-	-	-	-	-	-	-	-
7	61872	7-1	1/4	1.848	1-5/16	3/4	2-3/8	6-1/4	B.S.	4.00
7	51437	7-1	1/4	1.875	1-3/8	3/4	2-3/8	6-1/4	B.S.	6.20
7	3203	7-1	3/8	1.875	1-3/8	3/4	2-3/8	6-1/4	B.S.	6.20
-	-	-	-	-	-	-	-	-	-	-
7-1/2	2026452	8-7	5/8	1.569	1-1/2	1-3/8	2-1/16	6-15/16	F.S.	7.50
7-1/2	2026450	8-7	3/4	1.569	1-1/2	1-3/8	2-1/16	6-15/16	F.S.	7.50
-	-	-	-	-	-	-	-	-	-	-
7-5/8	51605	8-10	3/8	1.569	1-1/2	1-1/4	2-3/8	6-3/16	D.I.	7.00
7-5/8	5498	8-10	1/2	1.569	1-1/2	1-1/4	2-3/8	6-3/16	D.I.	7.00

McKissick Sheaves

# McKissick® Sheaves

"A" Nominal Outside Diameter (in.)*	Stock No.	Pattern Number	Wire Line Size (in.)	"D" Bore Size (in.)	Hub Width (in.)	Rim Width (in.)	"C" Nominal Hub Outside Dia. (in.)	"B" Nominal Tread Dia. (in.)	Material	Approx. Weight (lbs.)
7-5/8	51614	8-10	5/8	1.569	1-1/2	1-1/4	2-3/8	6-3/16	D.I.	7.00
-	-	-	-	-	-	-	-	-	-	-
8	2023466	8NS-3	1	2.750	2-1/2	2-3/8	4	5-1/4	F.S.	15.00
8	2023462	8NS-3	1-1/8	2.750	2-1/2	2-3/8	4	5-3/8	F.S.	15.00
8	2023152	8-2	3/4	1.876	1-3/4	1-5/8	2-9/16	6-5/16	F.S.	10.00
8	61710	8-2	1/2	1.848	1-5/16	1-1/4	2-7/16	6-5/8	F.S.	8.00
8	51589	8-2	1/2	1.875	1-1/2	1-3/8	2-7/16	6-5/8	F.S.	7.00
8	2023144	8-2	1/2	1.876	1-3/4	1-5/8	2-9/16	6-5/16	F.S.	10.00
8	51598	8-2	5/8	1.875	1-1/2	1-3/8	2-7/16	6-5/8	F.S.	7.00
8	2028226	8-2	5/8	1.876	1-3/4	1-5/8	2-9/16	6-5/16	F.S.	10.00
8	2023403	8-2	3/4	1.875	1-1/2	1-3/8	2-7/16	6-5/8	F.S.	7.00
8	2023385	8NS-2	3/4	2.500	2-5/16	2-1/8	3-1/4	6-1/8	F.S.	12.50
8	2023765	8NS-2	3/4	2.561	2-5/16	2-1/8	3-1/4	6-1/8	F.S.	10.25
8	2023385	8NS-2	3/4	2.500	2-5/16	2-1/8	3-1/4	6-1/8	F.S.	12.50
8	2023765	8NS-2	3/4	2.561	2-5/16	2-1/8	3-1/4	6-1/8	F.S.	10.25
-	-	-	-	-	-	-	-	-	-	-
8-1/2	61747	8-DI-8	3/8	1.848	1-5/16	1	2-3/4	7-1/2	D.I.	11.00
-	-	-	-	-	-	-	-	-	-	-
9-3/4	2026492	10-NS-3	3/8	2.998	2-3/16	1	3-3/4	8-3/4	F.S.	9.00
-	-	-	-	-	-	-	-	-	-	-
9-7/8	51918	10-11	3/8	3.000	1-3/4	1-1/8	3-3/4	8-9/16	F.S.	14.00
9-7/8	51749	10-1	1/2	1.375	1-1/2	1-3/8	3-1/4	8-1/2	F.S.	9.50
9-7/8	2023154	10-2	1/2	1.875	1-3/4	1-5/8	2-9/16	8-5/16	F.S.	14.50
9-7/8	6040	10-11	1/2	3.000	1-3/4	1-1/8	3-3/4	8-9/16	B.S.	14.00
9-7/8	5675	10-1	5/8	1.375	1-1/2	1-3/8	3-1/4	8-1/2	F.S.	9.50
9-7/8	2023169	10-2	5/8	1.875	1-3/4	1-5/8	2-9/16	8-5/16	F.S.	14.50
9-7/8	2023173	10-2	3/4	1.875	1-3/4	1-5/8	2-9/16	8-5/16	F.S.	14.50
9-7/8	2023435	10NS-2	3/4	2.561	2-5/16	2-3/16	3-1/2	8-1/8	F.S.	16.10
9-7/8	2023419	10NS-2	7/8	2.500	2-5/16	2-3/16	3-1/2	8-1/8	F.S.	15.00
9-7/8	2023427	10NS-2	1	2.500	2-5/16	2-3/16	3-1/2	8-1/8	F.S.	15.00
-	-	-	-	-	-	-	-	-	-	-
10	2023484	10NS-3	1-1/8	2.750	2-1/2	2-3/8	4	7-3/8	F.S.	19.00
10	2023784	10NS-5	1-1/8	4.000	2-1/2	2-3/8	5-3/4	7-3/8	F.S.	27.00
-	-	-	-	-	-	-	-	-	-	-
11-7/8	62096	12-6	1/4	2.998	2-3/16	1	3-3/4	10-3/4	D.I.	12.00
11-7/8	6193	12-6	3/8	3.000	2-5/16	1	3-3/4	10-3/4	D.I.	11.20
-	-	-	-	-	-	-	-	-	-	-
12	2023247	12-1	5/8	1.876	1-3/4	1-5/8	3-1/4	10-1/8	F.S.	18.00
12	2023234	12-1	3/4	1.876	1-3/4	1-5/8	3-1/4	9-3/4	F.S.	18.00
12	2023251	12-1	7/8	1.876	1-3/4	1-5/8	3-1/4	10-1/4	F.S.	18.00
12	2026531	12-9	5/8	3.000	1-3/4	1-5/8	4-1/2	10-1/8	F.S.	16.00
12	52285	12-9	3/4	3.000	1-3/4	1-5/8	4-1/2	9-3/4	R.F.	16.00
12	52132	12-2-A	5/8	2.500	2-5/16	2-3/16	4-1/2	10-1/8	R.F.	24.00
12	52141	12-2-A	3/4	2.500	2-5/16	2-3/16	4-1/2	9-3/4	R.F.	24.00
12	60007	12-2-A	3/4	2.750	2-5/16	2-3/16	4-1/2	9-3/4	R.F.	24.00
12	2026537	12-2-A	3/4	2.998	2-5/16	2-3/16	4-1/2	9-3/4	R.F.	24.00
12	74724	12-2-A	3/4	2.999	2-5/16	2-3/16	4-1/2	9-3/4	R.F.	24.00
12	2632	12-2-A	7/8	2.500	2-5/16	2-3/16	4-1/2	10-1/4	R.F.	24.00
12	2023553	12NS-3	7/8	2.750	2-1/2	2-3/8	4-1/2	10-1/4	R.F.	28.00
12	62283	12-2-A	7/8	2.998	2-3/16	2-3/16	4-1/2	10-1/4	R.F.	24.00
12	4016594	12-9	7/8	3.000	1-3/4	1-5/8	4-1/2	10-1/4	R.F.	23.00
12	52150	12-2-A	1	2.500	2-5/16	2-3/16	4	9-3/8	R.F.	24.00
12	2023551	12NS-3	1-1/8	2.750	2-1/2	2-3/8	4-1/2	9-3/8	R.F.	24.00
-	-	-	-	-	-	-	-	-	-	-
13	33653	13-2	3/8	2.500	1-1/2	1-1/8	3-1/2	11-5/8	R.F.	14.00
13	50704	13-2	1/2	2.500	1-1/2	1-1/8	3-1/2	11-5/8	R.F.	14.00
-	-	-	-	-	-	-	-	-	-	-
14	52374	14-1	5/8	1.876	1-3/4	1-5/8	3-1/4	12-1/8	R.F.	20.00
14	1964	14-1	3/4	1.876	1-3/4	1-5/8	3-1/4	11-3/4	R.F.	20.00
14	52383	14-1	7/8	1.876	1-3/4	1-5/8	3-1/4	12-1/4	R.F.	20.00
14	52668	14NS-3	7/8	2.750	2-1/2	2-3/8	4-1/2	12-1/4	R.F.	28.00
14	52677	14NS-3	1	2.750	2-1/2	2-3/8	4-1/2	11-3/8	R.F.	28.00
14	6442	14NS-3	1-1/8	2.750	2-1/2	2-3/8	4-1/2	11-3/8	R.F.	28.00
14	* 52720	14WL-8	1/2	4.250	2-1/2	1-3/8	5-1/16	12-5/8	D.I.	15.00
14	4013098	14-2	5/8	2.500	1-3/4	1-5/8	4-1/2	12-1/8	R.F.	31.00
14	4013187	14-2	5/8	2.375	1-3/4	1-5/8	4-1/2	12-1/8	R.F.	30.00
14	4015880	24S8-A	5/8	4.329	2-3/16	2-1/16	5-3/4	12-1/8	R.F.	30.00
14	4013196	14-2	3/4	2.375	1-3/4	1-5/8	4-1/2	11-3/4	R.F.	30.00
14	4013105	14-2	3/4	2.500	1-3/4	1-5/8	4-1/2	11-3/4	R.F.	31.00
14	4016503	24S7-A	3/4	3.250	2-5/16	2-3/16	5-1/2	11-3/4	R.F.	34.00
14	4015899	24S8-A	3/4	4.329	2-3/16	2-1/16	5-3/4	11-3/4	R.F.	32.00

# McKissick® Sheaves

"A" Nominal Outside Diameter (in.)*	Stock No.	Pattern Number	Wire Line Size (in.)	"D" Bore Size (in.)	Hub Width (in.)	Rim Width (in.)	"C" Nominal Hub Outside Dia. (in.)	"B" Nominal Tread Dia. (in.)	Material	Approx. Weight (lbs.)
14	4013114	14-2	7/8	2.500	1-3/4	1-5/8	4-1/2	12-1/4	R.F.	30.00
14	52695	14PL-8	7/8	2.500	2-5/16	2-1/8	4-1/2	12-1/4	R.F.	45.00
-	-	-	-	-	-	-	-	-	-	-
16	4010000	16-4	1/2	4.248	2-3/4	2-3/8	5-3/4	14-1/4	R.F.	44.00
16	4010046	16-17	3/4	4.248	2-3/4	2-1/2	5-3/4	13-3/8	R.F.	25.00
16	4010171	16-5	7/8	2.998	2-3/16	2-3/16	4-1/2	12-15/16	R.F.	35.00
16	4013294	16-5	7/8	3.000	2-5/16	2-3/16	4-1/2	12-15/16	R.F.	47.00
16	4013258	16-5	7/8	3.249	2-5/16	2-3/16	4-1/2	12-15/16	R.F.	47.00
16	4010126	16-17	1	4.248	2-3/4	2-1/2	5-3/4	13-3/8	R.F.	42.00
-	-	-	-	-	-	-	-	-	-	-
17	62559	17-6	5/8	4.722	2-3/4	2-1/2	6-1/2	15	R.F.	52.00
-	-	-	-	-	-	-	-	-	-	-
18	4010536	18-2	3/4	4.248	2-3/4	2-3/16	6-1/2	16	R.F.	54.00
18	4010493	18-2	7/8	3.499	2-5/16	2-3/16	5-1/2	14-15/16	R.F.	64.00
18	4012598	26FS-8	7/8	6.100	2-7/8	2-5/8	8	14-15/16	R.F.	86.00
18	4013490	18-2	1	3.250	2-5/16	2-3/16	5-1/2	14-7/8	R.F.	53.00
18	4013524	18-2	1	3.499	2-5/16	2-3/16	5-1/2	14-7/8	R.F.	64.00
18	4010439	26FS-7	1	4.500	3	2-3/4	6-1/2	15-1/8	R.F.	60.00
18	4012525	26FS-7	1-1/8	4.500	3	2-3/4	6-1/2	15-1/8	R.F.	60.00
-	-	-	-	-	-	-	-	-	-	-
20	*4014024	20-5	5/16	4.248	2-3/4	1-3/8	5-3/4	18-7/8	R.F.	45.00
20	4010616	20-2	3/4	3.500	2-5/16	2-3/16	5-1/2	18	R.F.	66.00
20	4010885	20-2	3/4	4.248	2-3/4	2-1/8	6-1/2	18	R.F.	80.00
20	4012614	32T-8	7/8	6.100	2-7/8	2-5/8	8	16-15/16	R.F.	70.00
20	4010634	20-2	1	3.500	2-5/16	2-3/16	5-1/2	16-1/2	R.F.	81.00
20	4013613	20-2	1	3.749	2-5/16	2-3/16	5-1/2	16-1/2	R.F.	76.00
20	4012703	32T-8	1	6.100	2-7/8	2-5/8	8	16-1/2	R.F.	80.00
20	4010625	20-2	7/8	3.500	2-5/16	2-3/16	5-1/2	16-15/16	R.F.	74.00
20	4010901	20-2	1	4.248	2-3/4	2-1/8	6-1/2	16-1/2	R.F.	80.00
-	-	-	-	-	-	-	-	-	-	-
24	4012749	24TS-8	9/16	6.498	3-3/8	3-1/8	8	22	R.F.	148.00
24	*4014408	24-5	5/8	4.722	2-3/4	1-1/2	6-1/2	21-3/4	R.F.	120.00
24	4011465	24TS-8	7/8	6.498	3-3/8	3-1/8	8	20-7/8	R.F.	128.00
24	4011385	24-1A	1	2.999	2-1/2	2-3/8	4-1/2	21-1/8	R.F.	125.00
24	4011214	42TS8-2	1	4.500	3	2-3/4	6-1/2	21-1/8	R.F.	135.00
24	4012785	42TS8-1	1	6.100	2-7/8	2-5/8	8	21-1/8	R.F.	130.00
24	4011474	24TS8	1	6.498	3-3/8	3-1/8	8	21-1/8	R.F.	124.00
24	4011223	42TS8-2	1-1/8	4.500	3	2-3/4	6-1/2	20-1/16	R.F.	130.00
24	4011553	42TS8-2	1-1/8	4.722	2-3/4	2-3/4	6-1/2	20-1/16	R.F.	127.00
24	4012794	42TS8-1	1-1/8	6.100	2-7/8	2-5/8	8	20-1/16	R.F.	120.00
24	4011483	24TS8	1-1/8	6.498	3-3/8	3-1/8	8	20-1/16	R.F.	132.00
24	4011410	24-10	1-1/2	6.498	3-3/8	3-1/8	8-1/4	20	R.F.	186.00
-	-	-	-	-	-	-	-	-	-	-
30	4011893	48T8-B	7/8	6.498	3-3/8	3-1/8	8	27	R.F.	187.00
30	4011900	48T8-B	1	6.498	3-3/8	3-1/8	8	27	R.F.	187.00
30	4011937	48T8-B	1	7.873	3-1/2	3-1/8	9-1/2	27	R.F.	255.00
30	4011919	48T8-B	1-1/8	6.498	3-3/8	3-1/8	8	27	R.F.	187.00
30	4011946	48T8-B	1-1/8	7.873	3-1/2	3-1/8	9-1/2	26-3/8	R.F.	221.00
30	4012507	48T8-B	1-1/4	7.873	3-1/2	3-1/8	9-1/2	26-3/8	R.F.	225.00
30	4011839	30-6	1-1/2	7.873	3-1/2	3-1/8	9-1/2	26	R.F.	244.00
-	-	-	-	-	-	-	-	-	-	-
36	4012222	36TS-8	1	8.873	3-5/8	3-1/4	11	31-1/4	R.F.	353.00
36	4012160	36TS-8	1-1/8	6.498	3-3/8	3-1/8	8-1/4	32-1/4	R.F.	341.00
36	4012231	36TS-8	1-1/8	8.873	3-5/8	3-1/4	11	32-1/4	R.F.	308.00
36	4012213	36TS-8	1-1/4	7.873	3-1/2	3-1/4	9-1/2	32-1/4	R.F.	340.00
36	4012106	36-3	1-1/4	8.873	3-5/8	3-1/4	11	32-1/4	R.F.	359.00
36	4012730	36-3	1-1/2	7.873	3-1/2	3-1/4	9-1/2	32	R.F.	302.00
-	-	-	-	-	-	-	-	-	-	-
42	4015844	66-F-8	1-1/8	8.873	3-5/8	3-1/4	11	38-1/2	R.F.	460.00
42	4015728	66-F-8	1-1/8	10.873	3-5/8	3-3/8	12-1/2	38-1/2	R.F.	443.00
42	4015853	66-F-8	1-1/4	8.873	3-5/8	3-1/4	11	38-3/8	R.F.	460.00
42	4015719	66-F-8	1-1/4	10.873	3-5/8	3-3/8	12-1/2	38-3/8	R.F.	443.00
-	-	-	-	-	-	-	-	-	-	-
48	4016736	48-3	2	13.873	4-1/8	3-3/4	17	42	R.F.	735.00
-	-	-	-	-	-	-	-	-	-	-
50	4016745	80-6-8	1-1/4	13.873	4-1/8	3-3/4	17	46-1/4	R.F.	675.00
-	-	-	-	-	-	-	-	-	-	-
55	4016282	55-1	1-1/8	6.498	3-3/8	3	8-1/4	51-1/8	R.F.	537.00

\* Without Flame Hardening.  
Material: B.S.=Bar Steel, C.I.=Cast Iron, F.S.=Forged Steel, D.I.=Ductile Iron, C.S.=Cast Steel, P.M.=Powdered Metal, R.F.=Roll Forged.