

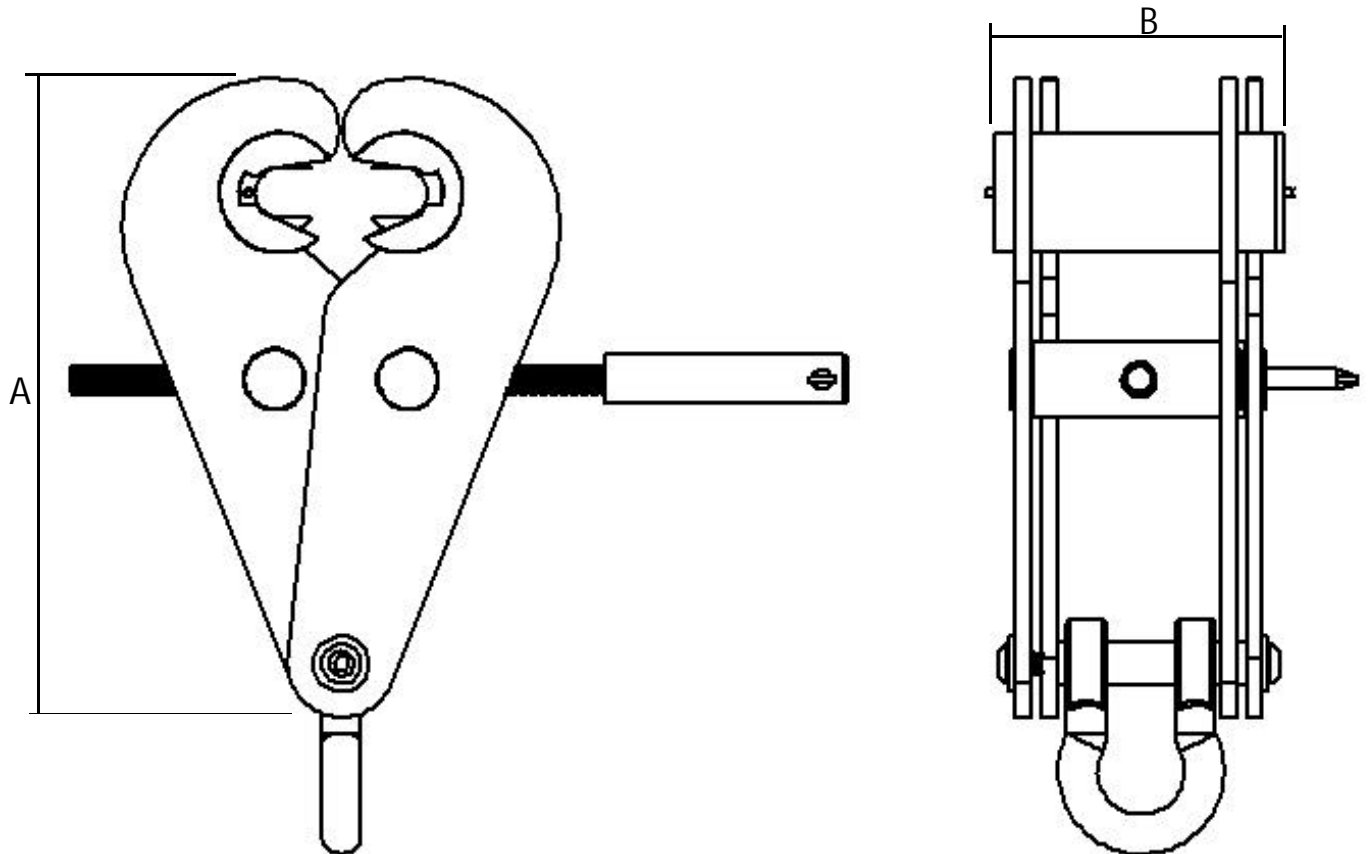

DESCRIPTION

The "Camlok" SCS Beam Clamp is based on our standard SC Clamps, and is fitted with swivelling jaws that provide a positive grip on the bottom flange of Rolled Steel Joists. As the clamp is tightened onto the bottom flange the jaw automatically rotates into the horizontal position, thus ensuring the full width of the jaw is in contact with the flanges.

DIAGRAM



TABLE

MODEL	WLL Tons	Flange Thickness mm	Flange Width mm	Weight kg	A	B
SCS2	2	80-305	20	8	325	136
SCS3	3	80-305	25	10	325	136
SCS5	5	80-305	25	14	Sizes Available On Request	
SCS10	10	80-305	30	20		