

Tiger Lever Hoist Model No TLH11



Main Features

- Range from 250kg – 10000kg
- Rugged steel body construction
- Lightweight and portable
- 360 degree handle rotation
- Short stroke and low lever pulling effort
- Easy single-hand “freewheeling” operation
- Drop forged & heat treated alloy hooks
- High quality alloy calibrated load chain
- Safe reliable twin pawl mechanical brake
- Guaranteed light load protection
- Heat treated alloy steel triple spur gears and pinion shaft
- Heavy duty chain end stop
- Operating temperature of -50°C to +50°C
- Proof tested to 1.5 times rated capacity
- 1.5m height of lift as standard but can be chained to exact requirements
- Individual spares readily available

Tiger TLH11 Heavy Duty Lever hoists

Lightweight, compact and rugged construction with the handle, gear case and brake cover made entirely of pressed steel, producing strong resistance to impact damage. Using only the highest quality materials precisely machined throughout ensures the TLH11 is the ideal hoist for long term use with less maintenance and servicing costs. These units meet and exceed all the requirements within BS EN 13157:2004

Safety Brake:

The highly efficient twin pawl brake, works instantly when the operation is stopped and securely holds the load. Designed and 100% tested to hold a 2% load of the rated capacity. The bonded friction discs are free of asbestos and achieve highly efficient braking.

Load Chains:

Tiger only use the highest quality alloy, calibrated load chains in Grade 80 (T) or 100 (V).

Hooks:

Drop forged and heat treated alloy hooks are furnished with heavy duty latch kits that fully engage into the nose of the hook offering maximum load security. The swivel hooks are attached to the yoke using high grade nuts & bolts allowing for complete inspection during any statutory inspection or written scheme maintenance. Recessed forgings offer full protection to the load chain anchor bolts on all our bottom hooks.

Grease:

High performance premium quality grease allows the TLH11 hoists to be certified for use within a temperature range of -50°C to +50°C far exceeding the requirements of current standards.

Chain end stops:

User friendly heavy duty end stops make it easy for the operator to position the chain whilst "freewheeling" but most importantly gives complete compliance to all known standards.

Mechanical Efficiency:

All major components are heat treated and precisely machined to ensure long term smooth operation. High gear ratios keep physical effort to a minimum.

Finish:

The TCB11 is finished in our high quality powder coat paint offering excellent corrosion protection.

Proof Load Tests:

Every lever hoist is fully tested to 1.5 times its rated capacity.

Technical Drawings

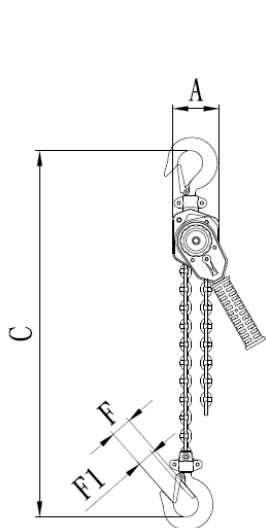

0.25t

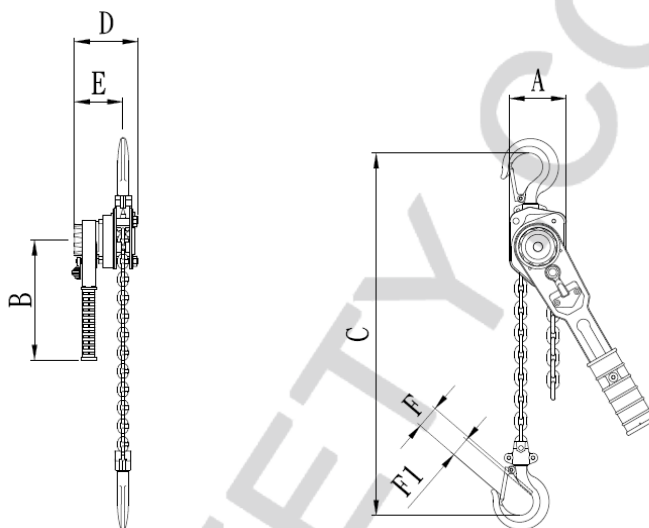

0.5t

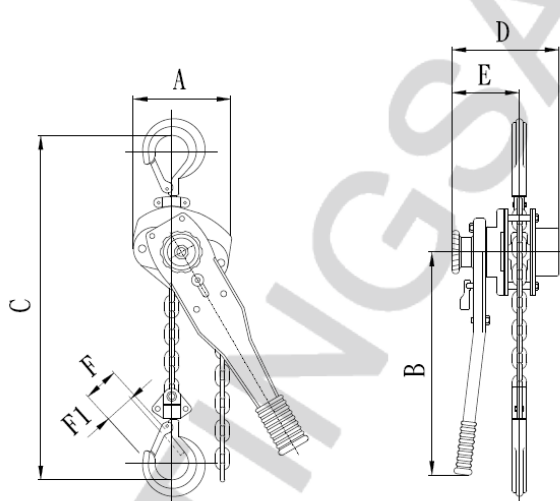

0.75t-3.0t

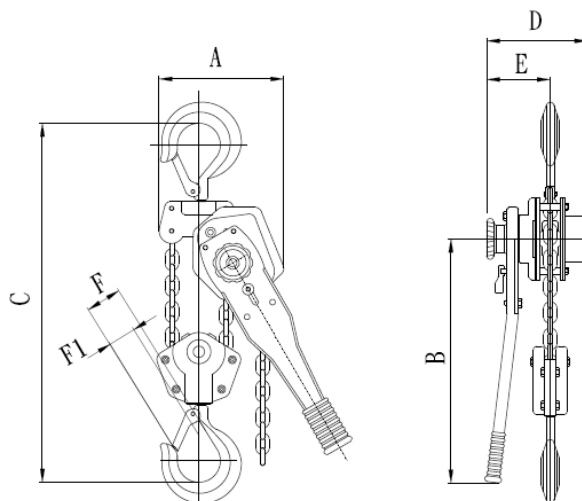

6.0t

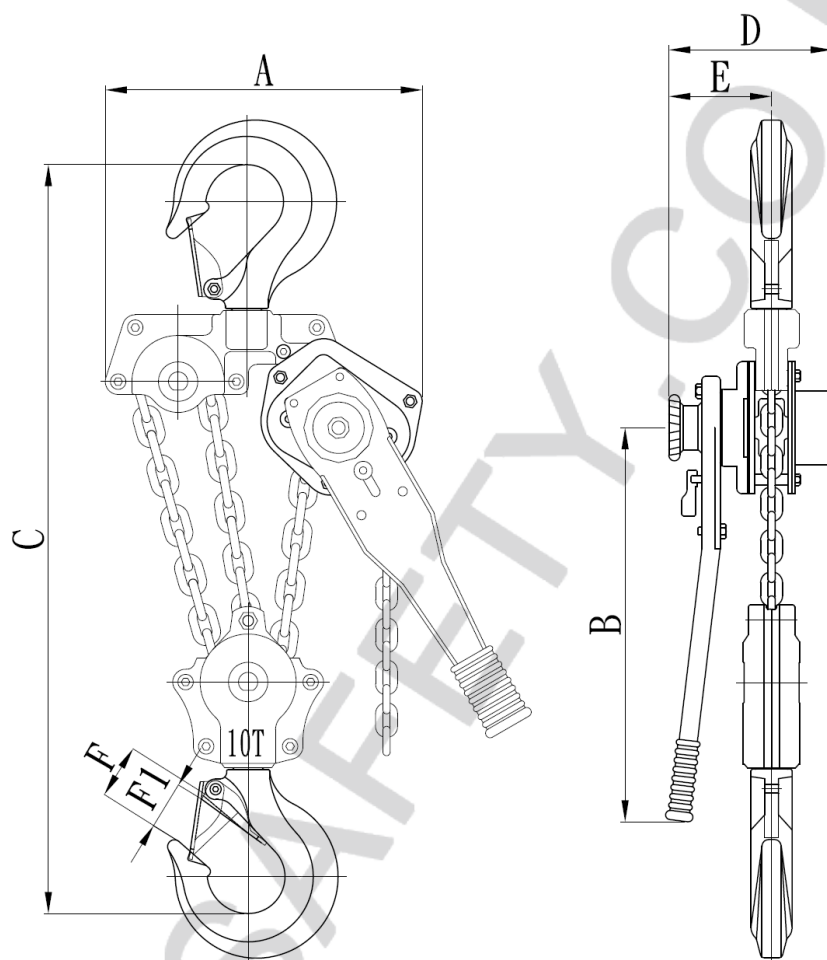

10.0t

Technical Data

Product Code	Capacity (tonne)	Effort (kg)	Dimensions (mm)							Load Chain		Standard HOL (m)	Mass Kg @ std HOL
			A	B	C	D	E	F	F1	Diameter (mm)	No. of falls		
LH-0025	0.25	30	60	156	245	82	63	27	22	ø4.0	1	1.0	2.2
LH-0050	0.5	34	75	276	270	100	75	30	26	ø5.0	1	1.0	3.9
LH-0075	0.75	22	128	240	275	158	99	30	26	ø6.3	1	1.5	7.2
LH-0150	1.5	26	154	360	320	172	104	38	34	ø7.1	1	1.5	10.1
LH-0300	3.0	38	182	360	400	195	108	43	38	ø10.0	1	1.5	18.0
LH-0600	6.0	40	242	360	570	195	108	57	52	ø10.0	2	1.5	28.0
LH-1000	10.0	47	370	360	630	195	108	71	56	ø10.0	3	1.5	42.4