

Applications

Lifting without marring of products with parallel sides made of various materials such as wood, concrete, steel, plastic, rock ...

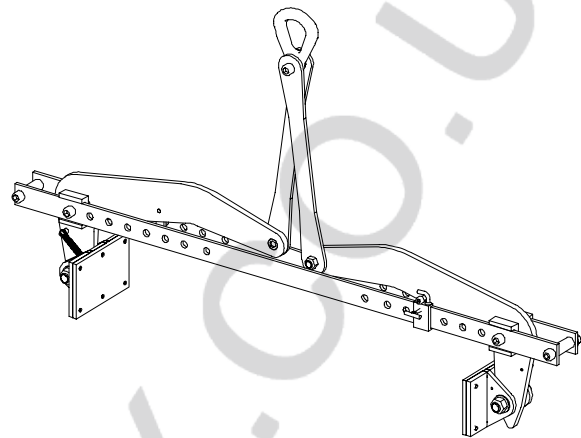
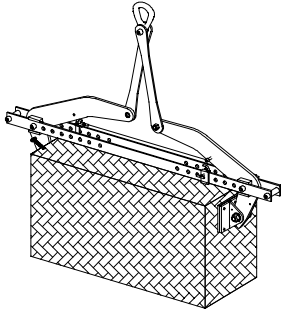

Description

These accessories are fitted with an open position locking system allowing the positioning on the load. Rubber coated pads ensure a great adherence and avoid load marring. Clamping is proportional to the load, thus minimising the damage risk.

Functioning

Adjust the clamp's opening, sliding the jaws' adjusting broach on either side (symmetrical adjustment from 200 to 1000 mm to a 100 mm-increment). Place the clamp locked open over the load. Unlock the catch hooks and perform lifting. Once the load has been laid down, slide back the catch hooks on their own pin so as to lock the clamp open.

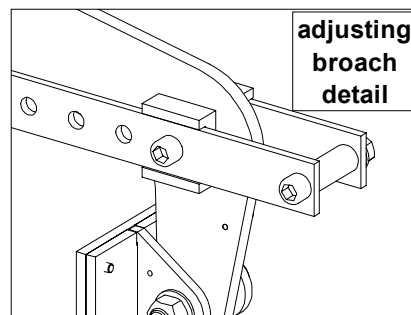
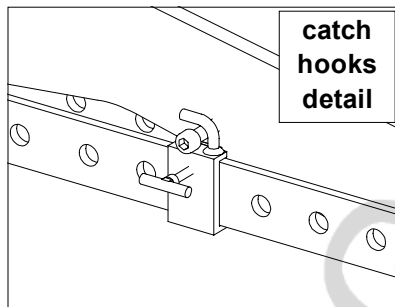

Particular instructions

- The pads must be free from grease or oil.
- Degrease the pads regularly.
- Do not lift greasy or oily pieces or with smooth surfaces (eg. polished marble).
- Only lift one load at a time.
- Do not lift blocks with a size exceeding the opening capacity of the clamp used.
- Both broaching positions of the clamp's arms should be symmetrical with relation to the lifting point.
- For each grasping dimension, observe the broaching positions to guarantee the gripping power necessary for lifting (see instructions for use).
- Working temperature: -20° to +90°C.

technical sheet	PP	ref. :	T 6008 GB
		rev. :	2
		date :	Jun. 03
		page :	2 / 2

adjustable clamp for loads with parallel sides

General characteristics

- Manufacture without load bearing welds.
- Hot epoxy coating.
- Safety factor: 4 in accordance with the European Materials Handling Federation (1998 FEM 3rd edition) ; working group A5 and lifting speed 60 m/ mn.

Dimensional characteristics

Ref.	Group code	WLL kg	Opening		A		B		C	D		F	G	H	I	J	K	L	Weight kg
			min	max	min	max	min	max		min	max								
PP1 200-1000	50608	1 000	200	1000	666	722	187	195	1440	560	1280	20	166	130	200	80	64	23	42

Dimensions in mm

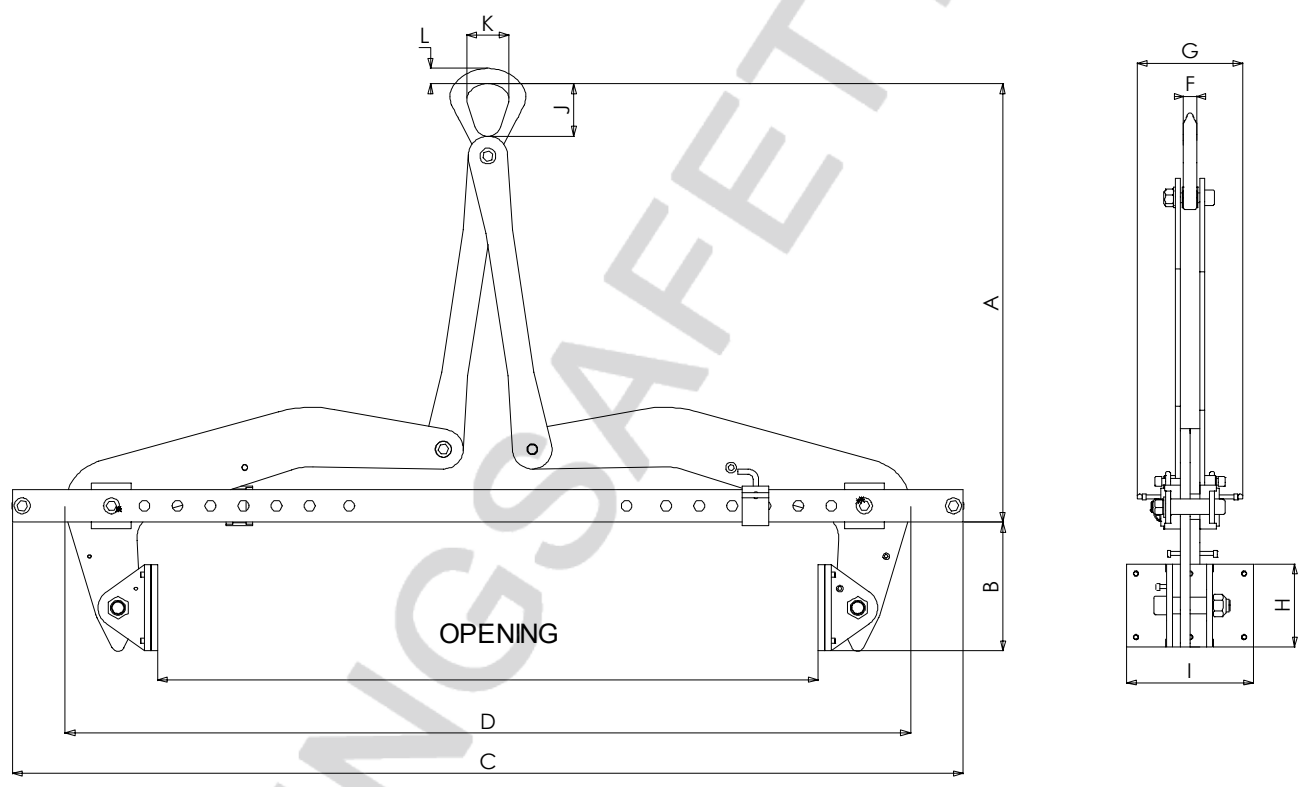

Options on request

- Pads coated with polyurethane/ abrasion steel.
- Pads with steel points (for slack loads).

