

SELBY ENGINEERING AND LIFTING SAFETY LTD. TEL: +44 (0) 1977 684 600

Laufkatze mit Kurbel
Girder trolley with crank
Chariots monorail à écartement avec manivelle

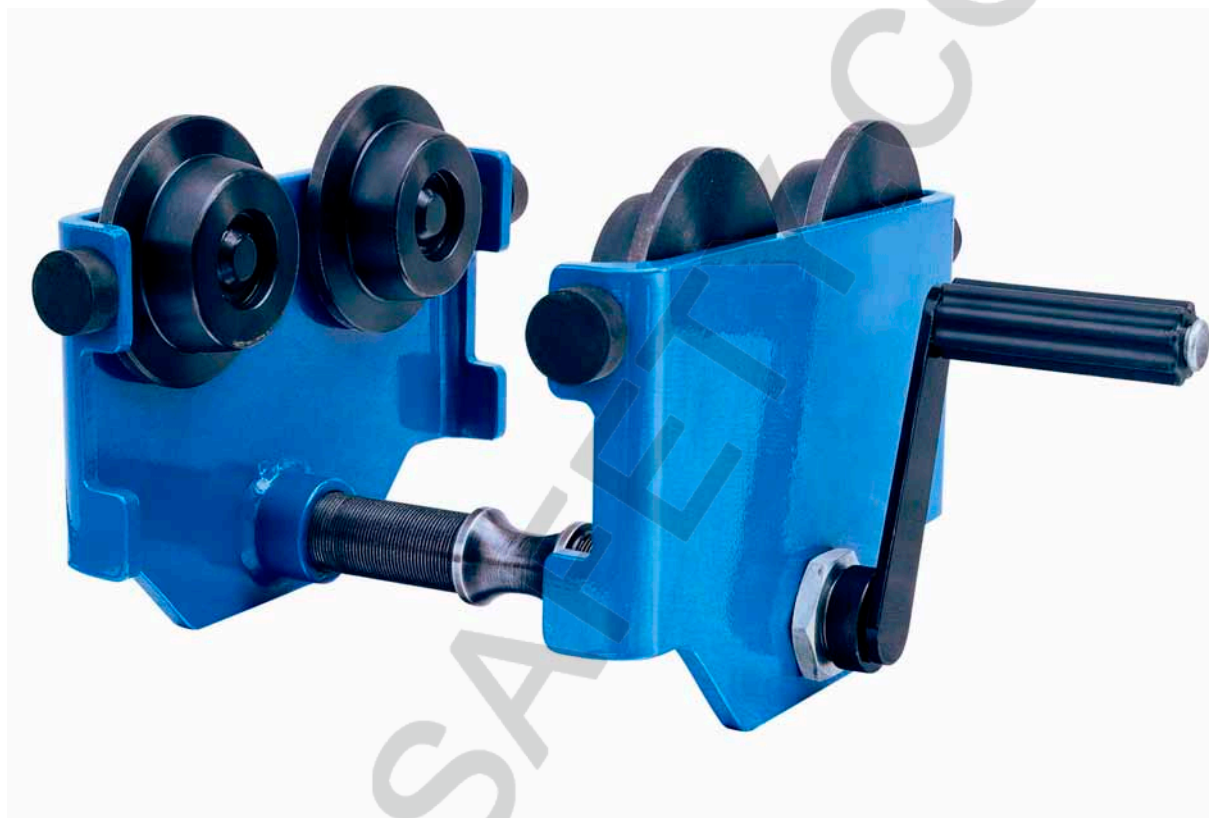

Traglast / capacity / capacité	Type	Flanschbreite / flange width / largeur
500	040013914	50 - 180
1000	040013915	66 - 188
2000	040013916	88 - 200

SELBY ENGINEERING AND LIFTING SAFETY LTD. TEL: +44 (0) 1977 684 600

Laufkatze mit Handkurbel
Girder trolley with crank
Chariots monorail à écartement avec manivelle

F09.09.002



Maßblatt / Dimension sheet / Page des dimensions

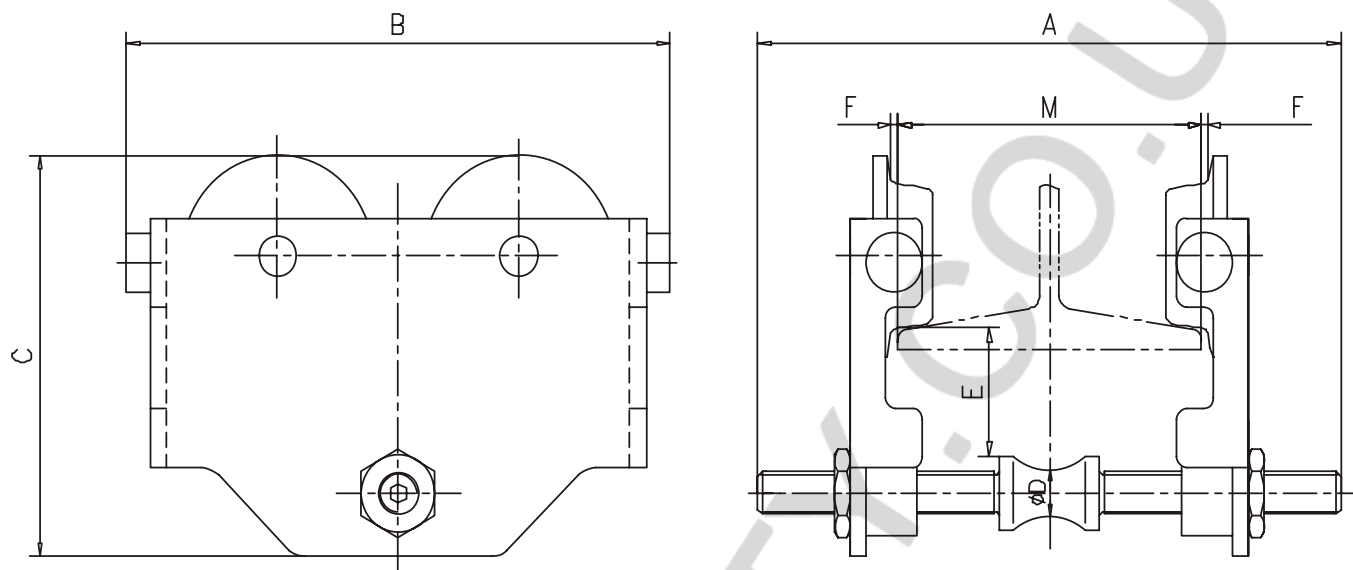

Type	Traglast capacity capacité [kg]	Flanschbreite flange width largeur (profil) M [mm]	A [mm]	B [mm]	C [mm]	ø D [mm]	E [mm]	F [mm]	Kurvenradius curve radius rayon de braquage min. [m]	Gewicht weight poids [kg]
040013914	500	50 - 180	234	223	159	18	52	1,5 -3	0,8	6
040013915	1000	66 - 188	256	270	190	22	60		1,0	11,5
040013916	2000	88 - 200	260	300	218	28	67		1,1	18

Read the operating manual carefully before use

Follow the safety instructions

Keep the document in a safe place



Proper usage

The girder trolley is a sliding chassis for attaching to lifting gear for use inside a crane.

Do not use a mechanical drive unit.

It is not suitable for permanent operation

It is not suitable for use in rooms where there is a potential risk of explosions

It is not suitable for use in aggressive atmospheres

The unit should be installed if possible in a covered room. If it is installed outdoors a roof is to be provided or the unit is to be covered.

Modifications to the lifting gear are only permitted with our express consent in writing

Refer to the technical data and function description.



Accident prevention regulations

Compliance with the regulations in force in the country of use is mandatory¹⁾

In Germany these are currently the following:

UVV BGV D 8 Winches and towing equipment

DIN EN 13157

BGR 500 – 2.8 Load handling equipment in lifting gear

DIN 685 Part 5; DIN 5684 Part 3; EN 818-7

EC Directive 98/37/EC

¹⁾The latest versions are applicable

Safety instructions

Operation and servicing must be left strictly to: authorized, trained personnel

(Definition of trained personnel pursuant to IEC 364): Trained personnel are people who, as a result of their education, experience, instruction and knowledge of the relevant standards and regulations, accident prevention regulations and operating conditions, have been authorized by the persons responsible for the safety of the system to carry out the necessary work and can identify and avoid possible dangers as they do so.

⇒ Only install the girder trolley on girders whose load capacity has been checked previously.

⇒ Do not install the girder trolley on angled girders.

⇒ Stops on the ends of girders must not be moved or removed.

⇒ Do not transport personnel or allow personnel to be located in the danger area.

⇒ Do not allow the load to swing.

⇒ Do not stand under a raised load.

⇒ Never reach into moving parts

⇒ Defects are to be rectified immediately by trained personnel.

⇒ Never leave the load off the ground without supervision

⇒ Loads may only be raised vertically. Do not raise loads at an angle.

⇒ Do not use the girder trolley to pull items out of other items, release them or drag them sideways.

⇒ The girder trolley may only be used to push or pull the load

⇒ Do not exceed the load capacity set out in the technical data

⇒ Check the raceway width and adjust the distance between the chassis flanges using the figures in the table

⇒ Never slew the load off the ground without supervision.

⇒ High strength parts must not come into contact with free hydrogen, acids, alkalis, vapour or very aggressive cleaning products. *They may become brittle and fracture.*

⇒ Conduct a risk analysis before use and verify EC conformity.

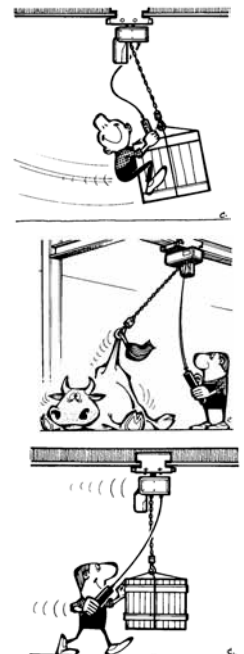

Daily examinations

⇒ Before you use the girder trolley check that it is correctly mounted on the girder.

⇒ Conduct a visual inspection of the rollers every day. Pay special attention to the lateral play between the raceway girder and the rollers.

⇒ Check that the bolts are secure and that the traverse is secure.

Conduct an EC conformity evaluation procedure and expert examination (in accordance with BGV D6) before using the equipment for the first time or for the whole unit (crane). An approved expert must be appointed to conduct this test in Germany.

An accident prevention regulations test by an expert must be conducted at least once a year.

Keep precisely to the inspection and servicing intervals

Commissioning

Function description

The roller chassis may only be pulled on the load, or the load hook of the lifting gear.

The roller chassis is to be attached to a horizontal raceway girder.

The raceway girder must be flat and horizontal.

The chassis width may be adjusted by a crank to the relevant girder width.

The chassis is designed without a brake.

The attached load may be moved either by pushing or pulling the load (sliding chassis).

The movement speed should be such that the load can be braked by the user at any time. Take the mass of the slewing load into account.

Installation of the girder trolley on the girder

The girder trolleys can be adjusted to various girder flange widths.

1. Establish the girder dimensions (M) (flange width)
2. Check conformity with the data sheet.

The trolley adjustment to the girder flange is to be effected by the crank.

After adjustment of the girder flange width, the side plates must be distorted by the 2 hexagon nuts with the girder.

3. Check the girder trolley for firm seat.

If necessary the crank can be dismantled (knurled thumb screw) during operation.

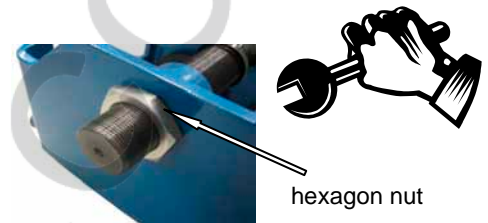

	0,5 t	1,0 t	2,0
hexagon nut	M24x1,5	M30x1,5	M36x1,5
wrench size	36	46	55

Media / Recommended lubricants

Recommended lubricant for greasing points:

Multi-purpose grease DIN 51825 T1 K2K



After use the lubricant must be disposed of in compliance with the statutory regulations.

Inspection and servicing instructions

Safety instructions

Remove all the strain from the girder trolley by suitable means before carrying out inspection and servicing work

Conduct an expert inspection before commissioning

Inspection intervals	Servicing and inspection work
Daily	Visual inspection of rollers (for signs of cracks and deformation) Function of the unit Adjustment range, visual inspection of the track width lateral play
Quarterly	The rollers are fitted with ball bearings that are lubricated for life
Every six months	Check screw connections. Grease the meshing on the rollers and drive pinion.
Every year	Check that the model plate is completely legible. Have the annual test carried out by an expert ¹⁾

¹⁾ For example by Pfaff-silberblau After-Sales personnel

The service life of the unit is limited, worn parts must be replaced promptly.



Troubleshooting

Problem	Cause	Remedy
The girder trolley can only be moved with difficulty.	No grease in the bearings and meshing.	Carry out servicing work.
	Dirt or other foreign bodies on load girder.	Clean
	Girder deformed	Repair

Disposal:

After they have been taken out of use, the parts of the girder trolley are to be recycled or disposed of in compliance with the statutory regulations.

