

# Crosby® Connecting Links



**S-247**



- All pins Alloy Steel - Quenched and Tempered.
- Body is forged and heat treated carbon steel.
- Designed for linking all popular sizes of Crosby Spectrum 3® and Spectrum 4® chain to rings, end links, eye hooks, pad eyes, tractor eyebolts, etc.
- Features quick and easy assembly.

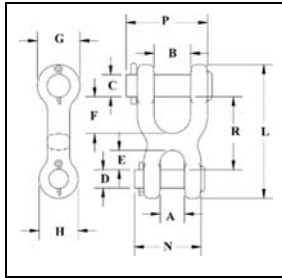

**S-247  
Double Clevis Link**

| Chain Size (in.) | S-247 Stock No. | Working Load Limit (lbs.)* | Weight Each (lbs.) | Dimensions (in.) |      |     |     |     |      |      |      |      |      |      |      |
|------------------|-----------------|----------------------------|--------------------|------------------|------|-----|-----|-----|------|------|------|------|------|------|------|
|                  |                 |                            |                    | A                | B    | C   | D   | E   | F    | G    | H    | L    | N    | P    | R    |
| 1/4              | 1013021         | 2600                       | .38                | .50              | .75  | .50 | .31 | .38 | .75  | 1.00 | .81  | 2.81 | 1.38 | 1.66 | 1.50 |
| 5/16-3/8         | 1013049         | 5400                       | .81                | .56              | 1.00 | .63 | .44 | .47 | 1.00 | 1.19 | 1.00 | 3.53 | 1.75 | 2.25 | 1.91 |
| 7/16             | 1013067         | 7200                       | 1.25               | .69              | 1.13 | .69 | .56 | .59 | 1.09 | 1.31 | 1.19 | 4.06 | 2.00 | 2.50 | 2.19 |
| 1/2              | 1013085         | 9200                       | 1.56               | .81              | 1.25 | .75 | .63 | .68 | 1.25 | 1.44 | 1.31 | 4.53 | 2.25 | 2.75 | 2.47 |

\* Ultimate Load is 4 times the Working Load Limit.

Not Suitable for use with Grade 80 or Grade 100 chain and chain slings used in overhead lifting.



**S-249**



- Available in three popular sizes.
- Body is forged and heat treated carbon steel.
- All pins Alloy Steel - Quenched and Tempered.
- Features quick and easy assembly.
- Twin Clevis design provides a variety of uses and can be used with Crosby Spectrum 3®, Spectrum 4® and Spectrum 7® chain.

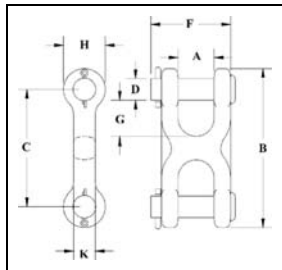

**S-249  
Twin Clevis Link**

| Chain Size (in.) | S-249 Stock No. | Working Load Limit (lbs.)* | Weight Each (lbs.) | Dimensions (in.) |      |      |     |      |     |      |     |
|------------------|-----------------|----------------------------|--------------------|------------------|------|------|-----|------|-----|------|-----|
|                  |                 |                            |                    | A                | B    | C    | D   | F    | G   | H    | K   |
| 1/4-5/16         | 1012861         | 4700                       | .31                | .47              | 2.50 | 1.56 | .38 | 1.31 | .43 | .94  | .50 |
| 3/8              | 1012889         | 6600                       | .44                | .53              | 2.81 | 1.81 | .44 | 1.53 | .50 | 1.00 | .56 |
| 7/16-1/2         | 1012905         | 11300                      | .98                | .65              | 3.62 | 2.31 | .56 | 1.91 | .63 | 1.31 | .81 |

\* Ultimate Load is 4 times the Working Load Limit.

Not Suitable for use with Grade 80 or Grade 100 chain and chain slings used in overhead lifting.