

Crosby® Connecting Links



SELBY ENGINEERING & LIFTING SAFETY LTD.
 Lifting Equipment and Height Safety Specialists
 www.liftingsafety.co.uk sales@liftingsafety.co.uk
 Tel: +44 (0) 1977 684 600 Fax: +44 (0) 1977 685 300

G-334 / S-334



- Forged Steel - Quenched and Tempered.
- Has larger inside dimensions making it easier to attach hooks or other fittings to the chain.
- An exclusive Crosby product.
- After making connections, rivets must be peened.

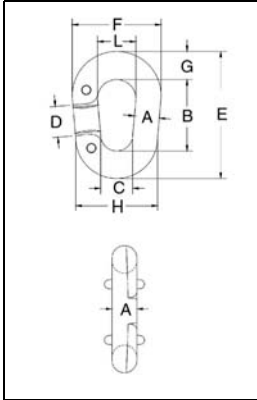

Pear Shape "Missing Link"® Replacement Links

Chain Size (in.)	Stock No.		Working Load Limit (lbs.)*	Weight Per 100 (lbs.)	Dimensions (in.)								
	G-334 Galv.	S-334 S.C.			A	B	C	D	E	F	G	H	L
3/8	1013432	1013441	1850	25.00	.41	2.00	.56	.81	2.94	1.63	.47	1.38	.81
1/2	1013450	1013469	3300	50.00	.50	2.50	.69	1.00	3.63	2.00	.56	1.69	1.00
5/8	1013478	1013487	5000	75.00	.63	2.75	.81	1.06	4.00	2.38	.63	2.06	1.13
3/4	1013496	1013502	7100	125.00	.75	3.13	1.00	1.13	4.75	2.75	.81	2.50	1.25
7/8	1013511	1013520	9600	200.00	.88	3.69	1.25	1.38	5.56	3.25	.94	3.00	1.50

* Ultimate Load is 4 times the Working Load Limit.

Not Suitable for use with Grade 80 or Grade 100 chain and chain slings used in overhead lifting.



G-335 / S-335



- Forged Steel - Quenched and Tempered.
- Integral rivets join the two halves.
- After making connections, rivets must be peened.

Meets or exceeds the performance requirements of Federal Specifications RRC-27ID, Type II, except for those provisions required of the contractor. For additional information, see page 391.

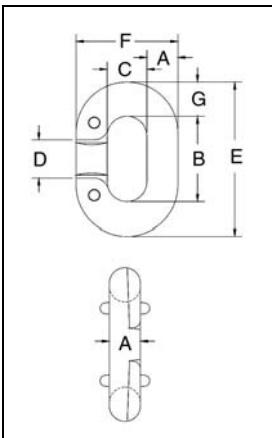

"Missing Link"® Replacement Links

Chain Size (in.)	Stock No.		Working Load Limit (lbs.)*	Links Per Box	Weight Per 100 (lbs.)	Dimensions (in.)						
	G-335 Galv.	S-335 S.C.				A	B	C	D	E	F	G
**3/16	1013094	1013101	800	20	2.50	.25	.69	.34	.34	1.19	.78	.28
**1/4	1013110	1013129	1325	10	6.25	.28	.88	.44	.44	1.50	1.00	.31
**5/16	1013138	1013147	1950	10	12.50	.34	.94	.47	.47	1.69	1.16	.38
3/8	1013156	1013165	2750	10	20.00	.41	1.13	.56	.56	2.06	1.38	.47
7/16	1013174	1013183	3625	10	27.50	.47	1.28	.59	.59	2.34	1.53	.53
1/2	1013192	1013209	4750	10	37.50	.53	1.47	.66	.66	2.66	1.72	.59
5/8	1013236	1013245	7250	10	72.50	.66	1.81	.78	.81	3.31	2.09	.75
3/4	1013254	1013263	10250	10	122.50	.78	2.13	.94	1.06	3.88	2.50	.88
7/8	1013272	1013281	12000	Bulk	175.00	.91	2.50	1.13	1.13	4.50	2.94	1.00
† 1	1013290	1013307	15500	Bulk	250.00	1.03	2.75	1.25	1.25	5.00	3.31	1.13

* Ultimate Load is 4 times the Working Load Limit.

** Rivets Only - No interlocking lugs.

† Has reinforced rivet holes. All sizes have countersunk rivet holes.

Not Suitable for use with Grade 80 or Grade 100 chain and chain slings used in overhead lifting.