

## IX - TROUBLESHOOTING

If the trolley does not move smoothly and freely along the traversing beam :

- Check that there is no obstacle on the traversing beam.
- Check that the running wheels run smoothly and correctly.
- Check that the running wheel pins are not damaged.
- Check that the spacing of the trolley is correctly adjusted in relation to the width of the traversing beam.
- Check that the curved radius of the traversing beam is not smaller than the technical capacities of the trolley used.
- Check that any curve is not distorted or twisted at any point.
- Check the good surface condition of the lower flange of the beam.

## X - HEALTH AND SAFETY AT WORK

It is the responsibility of every company to ensure that its employees have been fully and properly trained in the safe operation of the equipment.

Before using the equipment, check that all the safety devices are in place and operate correctly (section VI-5).

It is recommended that Travsafe trolleys must have an initial inspection on first installation and subsequent periodic inspection. Check local regulations and requirements.

# Travsafe®

## TBT: Beam Trolley

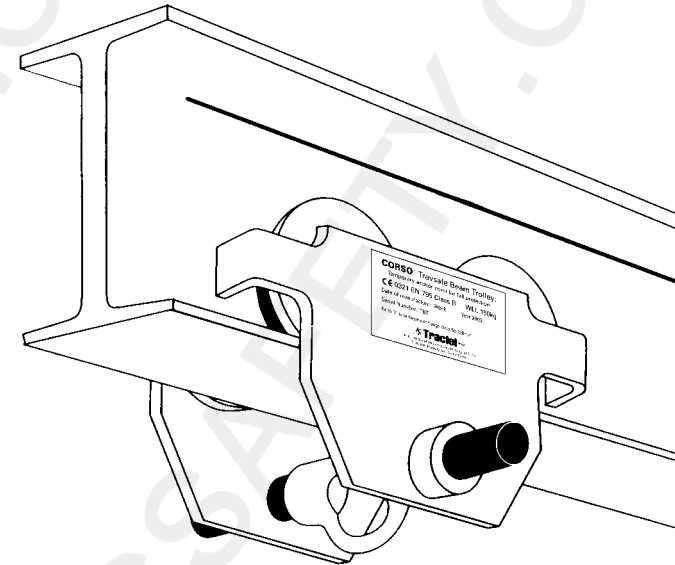

equipment  
in accordance with  
CE directives  
EN 795

operating  
and  
maintenance  
instructions

Tractel (UK) Ltd  
Old Lane,  
Halfway,  
Sheffield S20 3GA



Tel. 0114 248 2266  
Tel. 0114 247 3350  
E-mail. [info@tractel.com](mailto:info@tractel.com)  
Web Site. [www.tractel.com](http://www.tractel.com)



## CONTENTS

- I - Preface
- II - Compliance with safety standards and restrictions
- III - Important instructions
- IV- Guarantee
- V - General instructions
  - 1) Receipt of the equipment
  - 2) Installation
    - 2.1 Assembling and anchoring the device
    - 2.2 Anchoring the load
    - 2.3 Preliminary checks
    - 2.4 Control of movements
- VI - Technical data
  - 1) Operating principle
  - 2) Main subassemblies
  - 3) Name plate
  - 4) General specification
  - 5) Safety devices
- VII - Maintenance and inspection
- VIII - Servicing and lubrication
- IX - Troubleshooting
- X - Health and safety at work

## 1-PREFACE

You have just purchased a Travsafe travelling trolley. Thank you for choosing our equipment.

**Before using this equipment it is essential for operational safety to read these instructions and comply with their provisions and recommendations.**

These instructions must be kept near the device and must be read and understood by every user. Additional copies may be obtained by simply requesting them from our sales department.

**Before starting to use the Travsafe trolley the user must find out about the safety regulations which apply to the use of devices for lifting equipment.**

The Travsafe trolley may be used for carrying out operations which require a guaranteed high degree of safety. Accordingly, you must check that every individual who is entrusted with the task of operating this device is able to meet the safety requirements associated with these operations

## II - COMPLIANCE WITH SAFETY STANDARDS AND RESTRICTIONS

The Travsafe TBT Travsafe Trolley has been tested and approved in accordance with BS: EN 795 Class B for use as a portable anchorage device to protect against falls from height. The WLL is one person up to 150kg. If the trolley is involved in a fall arrest it must be inspected by a competent person immediately.

**Travsafe trolleys must not be used in explosive atmospheres.**

## 4) General specification

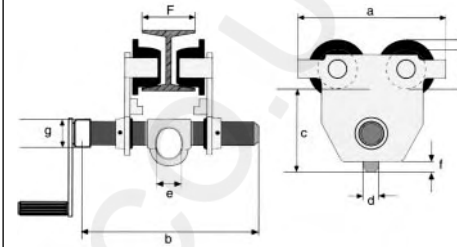

Model : TBT		
Dimensions		
a	mm	252
b	mm	334
c	mm	103
d	mm	17
e	mm	30
f	mm	17
g	mm	30
h	mm	62
i	mm	15
k	mm	100
r	mm	110
F	mm	58 - 220 220 - 300
Mini. curve radius	mm	1000
Weight	kg	10.5

## VIII - SERVICING AND LUBRICATION

Checks	Frequency	Person
Check general condition of trolley	Daily	Operator
Visual inspection of side plates and wheels (cracks, distortion)	Quarterly	Operator
Visual check of running wheels for wear	Six monthly	Operator
Check condition of traversing beam	Six monthly	Operator
General inspection of parts of the trolley for wear	Annually	After sales service centre

## 5) SAFETY DEVICES

Travsafe trolleys are fitted with the following

- Two securing screws to prevent relative motion between the side plates and the threaded suspension and adjustment bar
- Four formed sheet steel end stops acting as anti-derailing devices
- Anti-tilt devices welded on the internal surface of the side plates
- Four running wheels mounted on ball bearings

## VII - MAINTENANCE AND INSPECTION

Servicing of the Travsafe trolley consists of monitoring that it is in good condition, cleaning it and having it inspected periodically (at least once a year) by a repair engineer approved by TRACTEL.

Any damage to the Travsafe trolley, in particular on the running wheels and the side plates, must be repaired by an approved engineer before it is used again.

It is also essential to regularly check the condition of the traversing beam and if necessary clean it to prevent the accumulation of grease or dust which could prevent the trolley from moving correctly. The lifetime of the Travsafe trolley will depend on its regular maintenance in accordance with the directions and recommendations given in these instructions.

- Place the two wheels on the opposite side plate in contact with the traversing beam and turn the adjustment handle to bring the two side plates closer together and bring the four running wheels to rest on the lower flange of the beam
- Adjust the gap between the wheels as previously indicated
- Tighten the securing screws on the fixing rod to prevent the assembly from moving
- Remove the adjustment handle

After positioning the Travsafe trolley on the beam, it is essential to check, **WITH NO LOAD** on the trolley, that it moves smoothly and freely along the whole length of the beam.

### 2.2 Anchoring the load

The load suitable for use with the Travsafe trolley, must be fixed to the trolley using the anchor point provided. Loads must not, under any circumstances, be attached to any other part of the trolley.

### 2.3 Preliminary checks

- Check that all the parts of the trolley are correctly assembled and tightened
- Check that the trolley moves smoothly and freely along the whole length of the traversing beam
- Check that the traversing beam is sufficient to safely take the appropriate fall arrest load

### 2.4 Control of movements

Travsafe trolleys are moved along the traversing beam on the four running wheels which are mounted on ball bearings.

The following precautions should be taken when performing the various movements of the trolley:

- \* Avoid the Travsafe trolley systematically hitting the end stops fitted on the traversing beam
- Check that any curved radius of the beam is compatible with the specification of the trolley used

## VI - TECHNICAL DATA

### Main subassemblies

1. Trolley side plates
  - Securing screw for preventing the bar from moving
  - Anti-tilt system welded onto side plate
2. Threaded bar for fixing the side plates and gap adjustment
3. Anchor point
4. End stops acting as antiderailing devices
5. Running wheels

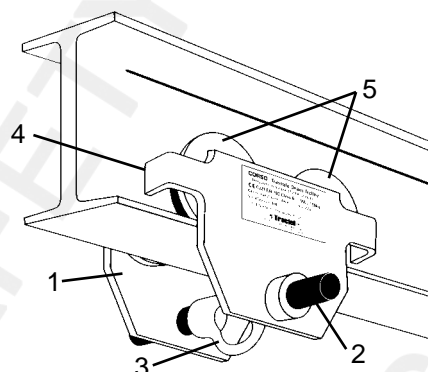

### 3) Name plate

**CORSO® Travsafe Beam Trolley:**  
Temporary anchor point for fall protection.

CE 0321 EN 795 Class B WLL 150kg

Date of manufacture: Week \_\_\_\_ Year 2003

Serial Number: TBT \_\_\_\_

Fit to 'I' type beams of flange sizes 58-220mm

R.N. 19 Saint-Hilaire-sous-Romilly B.P. 38  
F-10102 Romilly-sur-Seine Cedex

Travsafe trolleys should only be used with a maximum load equal to the nominal load shown on the name plate.

## WARNINGS AGAINST HAZARDOUS OPERATIONS

The operation of Travsafe trolleys in accordance with the instructions in this manual is a guarantee of safety, nevertheless, it is useful to draw the attention of users to the following warning :

- Do not mount the Travsafe trolley on sloping beams which are not fitted with a rack rail
- Never attempt to modify the Travsafe trolley, and in particular do not add a motor mechanism without the prior written consent of the manufacturer
- Never mount the Travsafe trolley on an unsuitable support as this may damage the components of the trolley
- Never repair the Travsafe trolley with spare parts which are not TRACTEL original spare parts
- Never allow an unqualified person or a person who has not read these instructions to use the Travsafe trolley.
- Never support a load heavier than the working load limit indicated on the trolley (it should be noted that accidental impacts to the suspended load or the suspended load bumping against fixed structures in the working area may cause overloads)
- Never use the Travsafe trolley to pull or release a load, or to pull a load laterally.
- Never touch or alter the components while the Travsafe trolley is in operation.
- Never intentionally cause the load to swing.
- Never use the Travsafe trolley under operating conditions or in an environment which do not comply with its specification. Never move and remove the end stops fitted at the end of the beam.
- Never use the Travsafe trolley which is in poor condition (worn or distorted)
- Never weld with the Travsafe trolley in the earth loop.
- Never remove the safety devices from the Travsafe trolley or use the trolley without these devices.
- Never fix the Travsafe trolley on the beam by any means other than those described in these instructions.

- Never suspend loads from the Travsafe trolley other than by the anchor point provided.
- Never mount the trolley on a beam without first checking the strength of the beam.
- Never walk or stand under a suspended load or cause the load to pass over persons.
- Never move a Travsafe push trolley other than by pushing or pulling on the load.

**IT IS EXTREMELY DANGEROUS AND CONTRARY TO ALL PRACTICES, DIRECTIVES AND REGULATIONS TO INTENTIONALLY OVERLOAD A LIFTING DEVICE. THE MANUFACTURER CANNOT BE HELD RESPONSIBLE IN THE EVENT OF ANY DAMAGE OR INJURY.**

### III - IMPORTANT INSTRUCTIONS

Check regularly that the Travsafe trolley is in good working order, in particular the running wheels. Never use a device which is not in apparent good working order.

Check that the traversing beam on which the Travsafe trolley is travelling is compatible with the intended load.

Before moving or performing any operation with the Travsafe trolley, check that it is correctly positioned on the traversing beam.

When moving a load, check that it is not likely to collide with any obstacles in the surrounding area.

Travsafe trolleys used out-of-doors must be adequately protected against adverse weather conditions.

If the device behaves abnormally or makes any suspicious noises when it is moved along the beam, the user must stop it immediately and inform a competent person. Any assembly of the Travsafe trolley following a procedure which does not comply with these instructions is the entire responsibility of the user or the fitter.

TRACTEL accepts no responsibility for the consequences of dismantling of the Travsafe trolley or any modification of the specification of the device by an organisation or a person not approved by TRACTEL, in particular in the case of the replacement of original parts by components not approved by the TRACTEL network.

#### IV - GUARANTEE

Our Travsafe travelling trolleys are guaranteed for a period of 12 months from the date of delivery from TRACTEL.

If dispatch from our factory is delayed for a reason which is not the responsibility of the vendor, the guarantee period may only be extended by a maximum of 3 months.

TRACTEL undertakes to correct, free of charge, any design, manufacturing or material defect recognised by our company after examination by our technical department, either by repair or replacement (at Tractel's discretion) of the product acknowledged as being defective. NO AUTOMATIC RETURN IS PERMITTED.

The guarantee does not cover damage resulting from incorrect use, inadequate maintenance or handling accidents. It does not cover normal wear and tear, ageing, the effects of oxidation or variations of voltage applied to electrical components. It does not apply to the paint or surface coatings.

The guarantee only applies to original TRACTEL parts, including the chains, and excludes all other components.

Repairs under guarantee are automatically performed in the workshops of the manufacturer or his approved representative. This guarantee commitment only applies to the cost of the parts replaced and the labour used. Any travelling or accommodation expenses incurred by TRACTEL personnel or those of TRACTEL's approved representative at the user's site, and the costs of transporting the item to and from the manufacturer's factory or that of his approved representative, remain the responsibility of the holder of the guarantee.

Parts which have been replaced become the property of the manufacturer and must be returned to him.

Any repair or modification work performed by the purchaser, the user or a third party not approved by TRACTEL, automatically invalidates the guarantee.

Repairs and replacements carried out in accordance with the guarantee will not extend the initial guarantee period. This guarantee excludes any work other than that defined above.

The performance of this guarantee excludes any acknowledgement of liability for damage or loss of any type.

The validity of our guarantee remains subject to the presentation of the guarantee certificate, duly signed and dated by the manufacturer, with the device in question. If necessary or in the absence of the guarantee certificate, it is subject to the purchase invoice being submitted to the TRACTEL network.

#### V - GENERAL INSTRUCTIONS

##### 1) Receipt of the equipment

Travsafe travelling trolleys are supplied in cardboard packaging with internal packing. When the equipment is received, carry out a visual inspection to check that the packaging is in good condition.

If there is any problem, express the usual reservations to the carrier.

After unpacking, check that the trolley corresponds to your order and that the delivery includes :

- Two identical side plates, each fitted with two running wheels
- One bar (with dual reverse thread) for fixing the side plates and adjusting the spacing
- One handle for adjusting the distance between the side plates of the trolley
- Two securing screws on the fixing bar
- These operating and maintenance instructions
- The CE declaration of conformity

#### 2) Installation

The lifetime of a trolley depends on how it is installed. It is essential to read these instructions carefully so that you install, use and maintain your device in a clean condition. Any use contrary to our instructions is dangerous and will release us from our liability as manufacturer. Do not use the device without having read these instructions in full and understood them.

These instructions must be kept close to the device at all times, available to the operator and the person responsible for maintenance. Follow the safety rules and ensure that they are followed by others.

##### 2.1 Assembling and anchoring the device

##### IMPORTANT:

**Before a Travsafe trolley is mounted on a traversing beam, the strength of the materials used in the beam must be calculated by a qualified person.**

If the Travsafe trolley is to be fitted in a location which is dangerous for the operator, the safety precautions laid down in the labour regulations must be implemented to remove all risks not covered in this operation.

Travsafe trolleys are supplied in kit form as standard. Before they are mounted on the traversing beam the subassemblies must be put together as follows :

- Hold the two side plates of the trolley either side of the fixing bar, checking that the screw threads on the fixing bar/side plates match.
- Rotate the fixing bar continuously to insert it on both sides into the thread provided in the side plates.
- When the threaded fixing bar has been screwed far enough through the side plates, attach the adjustment handle at the end of the fixing bar (on the side with the double drill hole).
- Turn the handle until the distance between the running wheels is adjusted to match the width of the traversing beam.

##### CAUTION :

The play between the flange of the running wheel and the edge of the lower flange of the traversing beam must not exceed 4 mm.

- When the adjustment has been correctly made, the oval part of the anchor point must be turned to point downwards so that it can subsequently take the suspension hook of the hoist.
- Position the copper washer in each hole to protect the thread and tighten the two securing screws on the fixing bar.
- Remove the adjustment handle.

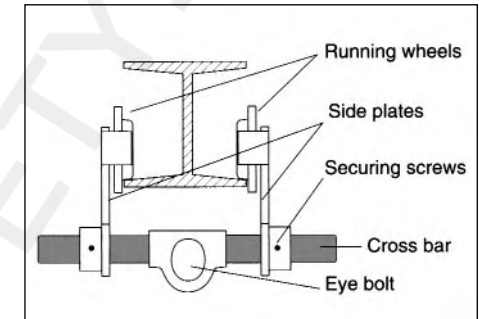

##### Procedure for mounting the trolley on the traversing beam

When the Travsafe trolley has been assembled as described above, it can then be fitted onto either end of the traversing beam.

Do not forget in this case to attach or replace the end stop on the traversing beam after fitting the trolley.

If the configuration of the traversing beam does not allow the trolley to be fitted at the end, the following procedure must be used :

- Hold the pre-assembled trolley assembly beneath the beam, keeping a wide enough gap between the running wheels to enable the trolley to be positioned on the beam
- Place two running wheels on one of the side plates in contact with the lower flange of the traversing beam