

INDIVIDUAL PROTECTIVE EQUIPMENT DESCRIPTION CARD FICHE DESCRIPTIVE D'EQUIPEMENT DE PROTECTION INDIVIDUELLE

Beschreibung der Individualschutzrüstung • Kaart met omschrijving van individuele beveiligingsuitrusting
 Scheda descrittiva dell' equipaggiamento di protezione individuale • Ficha descriptiva del equipo de protección individual contra caídas
 Ficha descriptiva de equipamento de protecção individual • Henkilösuojaukseen käytettävän välineistön määrittelylomake
 Datablad for udstyr til individuel beskyttelse • Kort som beskriver en personlig skyddsutrustning • Kontroll-liste for personlig verneutstyr •

Reference
Référénce

Serial number
N° de série

Kenn-Nr. / Codenummer / Riferimento / Referencia
Referência / Viitekoodi / Referens /
Referansnummer

Serien-Nr. / Seriennummer / N° di serie
Sarjanumero / Serien.

Purchase Date
Date d'achat

Manufacturing Year
Année de fabrication

Kaufdatum / Aankoopdatum / Data d' acquisto
Fecha de compra / Data de compra / Osto-pvm
Købsdato / Inköpsdatum / Kjøpsdato

Herstellungsjahr / Fabricagejaar / Anno di fabbricazione
Año de fabricación / Ano de fabrico / Valmistusvuosi
Fabrikasjonsår / Fabrikationsår / Tillverkningsår

Equipment assigned to
Equipement attribué à

Date of first use
Mise en service

Ausrüstung vergeben an / Uitrusting toebedeeld aan
Equipaggiamento attribuito a / Equipo atribuido a
Equipamento atribuído a / Kenen käyttöön laitteisto on
annettu
Udstyr tildelt / Udstyr tidelt / Utrustning tilldelad

Datum der ersten Inbetriebnahme / Datum van 1 ste ingebruikname
Data della 1a messa in servizio / Fecha de la 1ª puesta en servicio
Data de 1ª colocação em serviço / Ensimmäinen käyttöönotto-pvm.
Data for 1 ibrugtagning / Datum då utrustningen tas i bruk / Tatt i bruk første
gang den

INSPECTION - VERIFICATION

PRÜFUNG - CONTROLE - VERIFICHE - VERIFICACIONES - VERIFICAÇÃO
TARKASTUKSET - EFTERSYN - KONTROLL - KONTROLL UTFØRT -

	Date Datum Fecha Data Pvm. - Dato	Relevant organization or person Organisme ou personne compétente Prüfstelle oder zuständiger Fachmann - Bevoegde instelling of persoon Organismo o persona competente - Organismo ou pessoa competente valtuutettu henkilö tai organisaatio - Institution eller kompetent person Behörig organism eller person - Kompetent institusjon eller person	Result Résultat Ergebnis Resultaat Risultato Resultado tulos - Resultat
1			
2			
3			
4			
5			
6			

INDEX

GB English P.02-P.03

F Français P.04-P.05

D Deutsch P.06-P.07

E Español P.08-P.09

S Svenska P.10-P.11

Picture guide

Inspection sheet

In conformity with the provisions of Council Directive 93/42/EEC article 11 (5) and annex VII for Class I devices.

Important:

In order to ensure optimum safety and performance, please study and understand these instructions before using the product.

DESCRIPTION

Alphin MR and Alphin Lite Stretcher

The stretcher is shaped to fit the casualty i.e. narrow at the foot end tapering out up to its maximum width at the shoulder region then forming around the head in an ark.

The polypropylene bed is cut out around the perimeter enabling carrying without the use of the handles.

The casualty securing straps hold the casualty firmly and can be cross connected in any configuration to avoid injured areas. The shoulder straps positively locate the torso and are adjustable for casualty length and for being back-packed by the rescuer.

The adjustable stretcher lifting straps are of 44mm Nylon with ABS buckling system. Their individual break strength when new is 10kN. These straps are also designed to be used as carrying cross shoulder straps or maybe used for pulling and restraint.

Stretcher lift attachment points are welded completely through the bed frame and down one side. Their individual break strength when tested in a test laboratory at an angled pull similar to that of a single point lift (i.e. worst case scenario) = 13kN each.

The stretcher has been designed so that the weight of the casualty will stop the stretcher folding when carried. The locks must be engaged as this reduces movement when used as a sledge or for vertical lifts, also in casualty care where vomiting may occur and the stretcher requires to be positioned at an angle (not upside down in horizontal mode as this does not help the casualty or the stretcher).

Evac Body Splint

The stretcher is shaped to fit the casualty i.e. narrow at the foot end tapering out up to its maximum width at the shoulder region then forming around the head in a cone. The casualty securing straps hold the casualty firmly and can be cross connected in any configuration to avoid injured areas. An integral full body harness and adjustable

foot strap prevents the casualty sliding during vertical lift or adverse movement. The 2 main shoulder lifting loops are for vertical rescue. There are 4 carrying handles that can also be used to connect to lifting straps. Drag loops are located at both the head and foot of the splint. The single strap used for holding the splint in its rolled position can also be used as a head restraint strap when threaded through the side loops on the head cone of the splint.

EXTRAS ON REQUEST

(for Alphin MR and Alphin Lite Stretcher)

Head guard. This is an extra piece if required by the user. Made from 3mm Opaque polypropylene flat sheet. It is folded into position and locates in the four slots at the head end on the inner side of the top bends. See fitting instructions provided with product.

Wheel. Flat packs into 3 sections, easy fit to stretcher frame and located with pins. See diagram. Price on request.

NOTES FOR GUIDANCE

When unfolding the Stretcher, ensure that no debris, clothing, webbing or fingers become caught by the frame. Tension screw on lock mechanism so as to allow it to move freely against the spring washer, but not loose as this could cause damage when not in use. Inspect all buckles and webbing for any damage. Fold and adjust straps prior to packing into storage bag so it is left ready for use. It is advisable to keep a log of use, time and by whom, signed by superior. This may be kept in the bag. Connect all straps and adjust to allow Evac Body Splint to be flat prior to rolling and packing.

TRAINING

The Stretcher should be used by trained personnel. The manufacturer can provide suitable courses if required, please telephone or fax for details.

USE

The purpose of this stretcher and of this splint is for use in rescue or casualty transference only, in conditions where it is continually loaded.

INSPECTION AND MAINTENANCE

Webbing

Stretcher lifting straps are made from nylon
50mm casualty securing straps from polyester – Basket Stretcher only.
44mm & 25mm casualty securing straps from nylon – all stretchers.

Textiles

Inspect for cuts, tears and abrasions, damage due to deterioration, contact with heat, acids or other corrosives.

Sewing

Inspect for broken, cut or worn threads.

Snap Hooks & Maillons

Inspect for damaged or distorted hooks and threads and faulty springs on snap gates.

Buckles

The tongues of the plastic buckles should be carefully examined where fitted to the shoulder of buckles; inspect for open or distorted slider if fitted with 25mm or 50mm slide bar buckle and check for burrs or oxidization on any metal or alloy buckles.

Stretcher Frame & Bed

Periodically oil the hinge mechanism

Check for no sharp edges

Check screws on bed are secure

Check locking mechanism is in good working order

Ensure the stretcher is free from mud, etc

Clean out tube and wax oil for longer life every six months
After being in contact with salt water, clean down with fresh water and allow to dry

CLEANING

First rinse in cold clean water. If still soiled wash in warm water of domestic supply quality (maximum temp. 40°C) with pure soap or a mild detergent, at the appropriate dilution and within a pH range of 5.5 to 8.5, thoroughly rinse and dry naturally in a warm room away from direct heat.

Chemicals

Avoid all contact with any chemicals which could affect the performance of the product. These include all acids and strong caustic substances (e.g. vehicle battery acid, bleach etc.). Discard the product immediately if contact occurs or is even suspected. A list of chemicals and their effect is available on request. If used in a marine environment always thoroughly rinse the product in clean cold water after each use.

GRAPHICS

Alphin MR and Alphin Lite Stretcher

1. CARRYING POSITIONS

- > Positions also used for both Alphin Lite and Alphin Basket stretchers. (A)
- > Highly recommended position for long haul carrying. (B)

2. RECOMMENDED HORIZONTAL CONNECTIONS

- > Single point / connection point. (C)

- > Double connection points. (D)
- > Foot end. (E)
- > Head end. (F)

3. ALPHIN WHEEL

- > Approximate center of balance. (G)

4. RECOMMENDED VERTICAL CONNECTIONS

- > Adjustable lifting straps used for feet support. (H)
- > Lower or Lift. (I)
- > Pull. (J)
- > Safety sling. (K)
- > Adjustable lift straps used for feet support and rope link to stretcher. (L)

5. HEADGUARD LOCATION FOR STRETCHER

1. Fold and connect front location feet into slots A.
2. Hinge down to make location complete.
3. Push forward, insert back feet into slot until they locate.
4. Fold Velcro straps around frame for extra security.
5. Fold flaps in and back down, then lift point A over frame to locate on inside B.

Evac Body Splint

- > Secondary Haul Loop for Vertical Lifts & Main Drag Loop. (A)
- > Adjustable Strap to form Cone Shape. (B)
- > Main Haul Loop for Vertical Lifts. (C)
- > 3 x 50mm -Casualty Body Straps. (D)
- > Integral Body Harness with Padded Crutch Straps. (E)
- > 4 x 50mm Lifting Carrying Loops Also Vertical Lowers & Hauling. (F)
- > 3 x 25mm CASUALTY LEG STRAPS. (G)
- > Padded Adjustable Foot Strap. (H)
- > Foot End Drag Loop. (I)
- > Foot loop or head loop to be used only for vertical lifts or dragging. Side loops to be used for lifting horizontal with 2 – 4 men. (K)
- > Body / Splint . (J)
- > Storage / Carrying Bag with extra room to carry small First Aid Kit plus Std. neck brace and blow-up splint if required. These items are not included or sold by us. (J)

SPECIFICATIONS	Alphin MR	Alphinlite Stretcher	Evac Body Splint
Weight : Stretcher, complete with Casualy Security Straps	15, 44 kg	13,74 kg	/
Weight : Handles	3, 26 kg	/	/
Weight : (lifting strap)	1, 40 kg	1, 40 kg	/
Weight : (storage bag)	1, 44 kg	1, 44 kg	/

Material : mild steel tube - main frame & skis polypropylene - bed

DIMENSIONS	Alphin MR	Alphinlite Stretcher	Evac Body Splint
Length : open	2000 mm	2000 mm	2000 mm
Length : folded	1000 mm	1000 mm	1000 mm
Depth : (top of bed to ski base)	110 mm	90 mm	/
Depth : folded	150 mm	130 mm	Ø 250 mm
Width : (maximum at shoulder area)	590 mm	590 mm	/
Width : (minimum each end)	200 mm	200 mm	/

WINGING Raf Strike Command approved for lift into helicopters (for Alphin MR and Alphinlite stretcher)

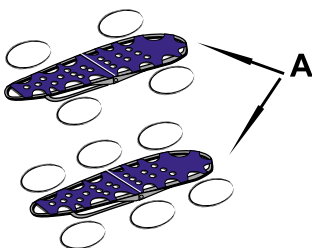
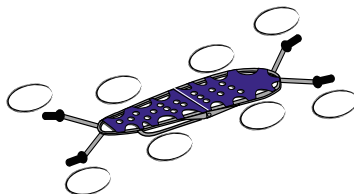
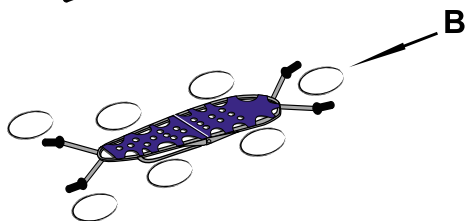
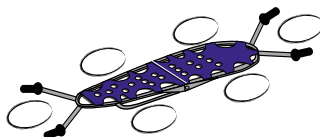
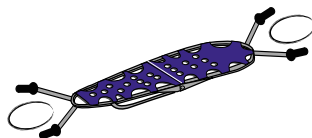
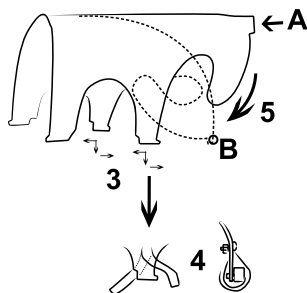
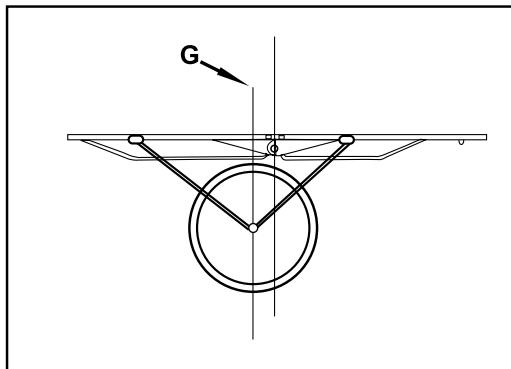
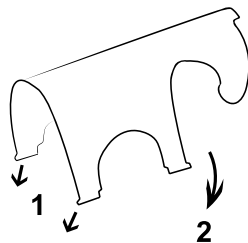
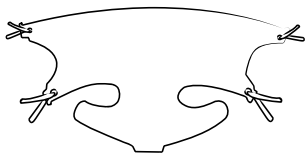

B

A

