

McKissick® Sheaves

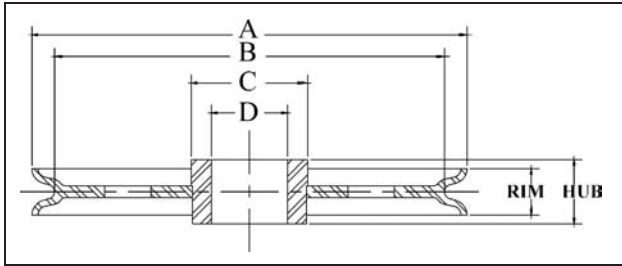

SEE APPLICATION AND WARNING INFORMATION

Para Español: www.thecrosbygroup.com See Pages 342-349

SELBY ENGINEERING & LIFTING SAFETY LTD.
 Lifting Equipment and Height Safety Specialists
www.liftingsafety.co.uk sales@liftingsafety.co.uk
 Tel: +44 (0) 1977 684 600 Fax: +44 (0) 1977 685 300

Common Bore Sheaves

- Roll Forged™ sheaves are available in sizes up to 72" in diameter.
- Common Bore or Plain Bore are terms used when there is merely a hole bored in the center of the sheave.
- Common Bore Sheaves are machined for a running fit for the shaft size listed.

"A" Nominal Outside Diameter (in.)*	Stock No.	Pattern Number	Wire Line Size (in.)	"D" Bore Size (in.)	Hub Width (in.)	Rim Width (in.)	"C" Nominal Hub Outside Dia. (in.)	"B" Nominal Tread Dia. (in.)	Material	Approx. Weight (lbs.)
3	905051	1161	3/16	3/8	25/32	3/4	1	2-3/8	P.M.	1.00
3	905079	1161	3/16	1/2	25/32	3/4	1	2-3/8	P.M.	1.00
3	905097	1161	3/16	5/8	25/32	3/4	1	2-3/8	P.M.	1.00
3	905024	1161	1/4	3/8	1/2	1/2	1	2-5/8	P.M.	.75
3	905042	1161	1/4	1/2	1/2	1/2	1	2-5/8	P.M.	.75
3	15410	1161	3/8	3/8	25/32	3/4	1	2-3/8	P.M.	1.00
3	905088	1161	3/8	1/2	25/32	3/4	1	2-3/8	P.M.	1.00
3	905104	1161	3/8	5/8	25/32	3/4	1	2-3/8	P.M.	.60
-	-	-	-	-	-	-	-	-	-	-
4	905113	1161	3/16	1/2	3/4	5/8	1-3/8	3-1/2	P.M.	1.00
4	905131	1161	3/16	5/8	3/4	5/8	1-3/8	3-1/2	P.M.	1.00
4	905122	1161	5/16	1/2	3/4	5/8	1-3/8	3-1/2	P.M.	1.00
4	905140	1161	5/16	5/8	3/4	5/8	1-3/8	3-1/2	P.M.	1.00
4	905168	1161	3/8	1/2	13/16	3/4	1-1/2	3-1/4	P.M.	1.25
4	905186	1161	3/8	5/8	13/16	3/4	1-1/2	3-1/4	P.M.	1.25
4	905202	1161	3/8	3/4	13/16	3/4	1-1/2	3-1/4	P.M.	1.25
4	905220	1161	1/2	1/2	1-1/16	1	1-5/8	3-3/16	P.M.	1.50
4	905248	1161	1/2	5/8	1-1/16	1	1-5/8	3-3/16	P.M.	1.50
4	905266	1161	1/2	3/4	1-1/16	1	1-5/8	3-3/16	P.M.	1.50
-	-	-	-	-	-	-	-	-	-	-
5	905275	1161	3/16	5/8	15/16	7/8	2-1/4	4-1/4	P.M.	2.25
5	905293	1161	3/16	3/4	15/16	7/8	2-1/4	4-1/4	P.M.	2.25
5	905284	1161	3/8	5/8	15/16	7/8	2-1/4	4-1/4	P.M.	2.75
5	905300	1161	3/8	3/4	15/16	7/8	2-1/4	4-1/4	P.M.	2.25
5	905328	1161	1/2	5/8	1-1/16	1	2-1/4	4	P.M.	2.50
5	905364	1161	1/2	5/8	1-3/16	1-1/8	2-1/4	4	D.I.	4.00
5	905346	1161	1/2	3/4	1-1/16	1	2-1/4	4	P.M.	2.50
5	905382	1161	1/2	3/4	1-3/16	1-1/8	2-1/4	4	D.I.	4.00
5	905408	1161	1/2	7/8	1-3/16	1-1/8	2-1/4	4	D.I.	4.00
-	-	-	-	-	-	-	-	-	-	-
6	905426	1161	3/8	1/2	13/16	3/4	1-7/8	5	D.I.	2.50
6	905480	1161	3/8	1/2	1-1/16	1	1-7/8	5	D.I.	2.50
6	905462	1161	3/8	3/4	13/16	3/4	1-7/8	5	P.M.	2.50
6	905523	1161	3/8	3/4	1-1/16	1	1-7/8	5	P.M.	4.16
6	909020	1181	1/2	7/8	1-1/16	1	1-7/8	4-7/8	P.M.	3.75
6	909066	1181	5/8	3/4	1-5/16	1-1/4	1-7/8	4-3/4	P.M.	3.75
6	909084	1181	5/8	7/8	1-5/16	1-1/4	1-7/8	4-3/4	P.M.	3.75
6	909100	1181	5/8	1	1-5/16	1-1/4	1-7/8	4-3/4	P.M.	3.75
6	909164	1181	3/4	1	1-9/16	1-1/2	3	4-5/8	P.M.	6.75
-	-	-	-	-	-	-	-	-	-	-
6-3/4	905694	1161	1/4	3/4	1-3/16	1-1/8	2	5-7/8	D.I.	5.00
6-3/4	905710	1161	1/4	1	1-3/16	1-1/8	2	5-7/8	D.I.	5.00
6-3/4	905701	1161	3/8	3/4	1-3/16	1-1/8	2	5-7/8	D.I.	5.00
6-3/4	905729	1161	3/8	1	1-3/16	1-1/8	2	5-7/8	D.I.	5.00
-	-	-	-	-	-	-	-	-	-	-
8	905747	1161	1/2	3/4	1-1/8	1	2-3/8	6-7/8	D.I.	5.00
8	905765	1161	1/2	7/8	1-1/8	1	2-3/8	6-7/8	D.I.	5.00
8	905783	1161	1/2	1	1-1/8	1	2-3/8	6-7/8	D.I.	8.50
8	905809	1161	5/8	3/4	1-3/8	1-1/4	2	6-1/2	D.I.	6.00
8	905827	1161	5/8	7/8	1-3/8	1-1/4	2	6-1/2	D.I.	6.75
8	909306	1181	5/8	7/8	1-3/8	1-1/4	2-1/2	6-5/8	D.I.	8.50

McKissick® Sheaves

"A" Nominal Outside Diameter (in.)*	Stock No.	Pattern Number	Wire Line Size (in.)	"D" Bore Size (in.)	Hub Width (in.)	Rim Width (in.)	"C" Nominal Hub Outside Dia. (in.)	"B" Nominal Tread Dia. (in.)	Material	Approx. Weight (lbs.)
8	905845	1161	5/8	1	1-3/8	1-1/4	2	6-1/2	D.I.	6.75
8	909324	1181	5/8	1	1-3/8	1-1/4	2-1/2	6-5/8	D.I.	8.50
8	909342	1181	5/8	1-1/8	1-3/8	1-1/4	2-1/2	6-5/8	D.I.	8.50
8	909360	1181	5/8	1-1/4	1-3/8	1-1/4	2-1/2	6-5/8	D.I.	8.50
8	909388	1181	5/8	1-1/2	1-3/8	1-1/4	2-1/2	6-5/8	D.I.	8.50
-	-	-	-	-	-	-	-	-	-	-
10	905925	1161	1/2	7/8	1-1/8	1	2-7/8	8-3/4	D.I.	10.00
10	905943	1161	1/2	1	1-1/8	1	2-7/8	8-3/4	D.I.	10.00
10	905961	1161	5/8	3/4	1-3/8	1-1/4	2	8-1/2	D.I.	9.25
10	905989	1161	5/8	7/8	1-3/8	1-1/4	2	8-1/2	D.I.	9.25
10	909681	1181	5/8	7/8	1-3/8	1-1/4	3	8-1/2	D.I.	13.50
10	906005	1161	5/8	1	1-3/8	1-1/4	3	8-1/2	D.I.	9.25
10	909761	1181	5/8	1-1/2	1-3/8	1-1/4	3	8-1/2	D.I.	13.50
-	-	-	-	-	-	-	-	-	-	-
12	906041	1161	1/2	1	1-1/8	1	4	10-5/8	D.I.	16.50
12	906087	1161	1/2	1-1/4	1-1/8	1	4	10-5/8	D.I.	16.50
12	906121	1161	3/4	1	1-5/8	1-1/2	2-3/4	10-1/4	D.I.	18.25
12	910107	1181	3/4	1	1-5/8	1-1/2	5-1/4	10-1/4	D.I.	25.50
12	906149	1181	3/4	1-1/8	1-5/8	1-1/2	2-3/4	10-1/4	D.I.	18.25
12	910125	1181	3/4	1-1/8	1-5/8	1-1/2	5-1/4	10-1/4	D.I.	25.50
12	906167	1161	3/4	1-1/4	1-5/8	1-1/2	2-3/4	10-1/4	D.I.	18.25
12	910143	1181	3/4	1-1/4	1-5/8	1-1/2	5-1/4	10-1/4	D.I.	25.50
12	910161	1181	3/4	1-1/2	1-5/8	1-1/2	5-1/4	10-1/4	D.I.	25.50
12	906229	1161	7/8	1-1/4	2	1-3/4	3-3/4	10	D.I.	20.25
12	906247	1161	7/8	1-1/2	2	1-3/4	3-3/4	10	D.I.	20.25
-	-	-	-	-	-	-	-	-	-	-
14	*906283	1161	3/4	1-1/8	1-5/8	1-1/2	3-1/4	12-1/4	C.I.	26.50
14	*906309	1161	3/4	1-1/4	1-5/8	1-1/2	3-1/4	12-1/4	C.I.	26.50
14	*910456	1181	7/8	1-1/2	1-5/8	1-1/2	3-1/2	12-1/8	C.I.	34.00
14	*910447	1181	7/8	1-1/4	1-5/8	1-1/2	3-1/2	12-1/8	C.I.	34.00
-	-	-	-	-	-	-	-	-	-	-
16	910713	1181	1	2	2	1-3/4	4-1/2	13-5/8	R.F.	47.00
16	910697	1181	1	1-1/2	2	1-3/4	4-1/2	13-5/8	R.F.	47.00
-	-	-	-	-	-	-	-	-	-	-
18	910820	1181	1	2	2	1-7/8	4	14-7/8	R.F.	62.00

* Without Flame Hardening.
Material: B.S.=Bar Steel, C.I.=Cast Iron, F.S.=Forged Steel, D.I.=Ductile Iron, C.S.=Cast Steel, P.M.=Powdered Metal, R.F.=Roll Forged.